

Labor and Materials

Copper } Connection.....	3	\$ 3.20
Lead }	2	
Curb } Cock Valve }	3	\$ 1.75
} T. S. & V. }	1	
Service Box } Short 21 x 14 }		\$ 1.40
Old returned } Long 43 x 53 }		
} Buff. or Rutway }		
28 Ft. } 3/4 in. } Copper } Pipe at.....		\$ 6.16
} } Cast Iron }		
Nipples.....	in. at.....	\$
Bushings.....	3/4 to 1/2 in. at.....	\$ 1.07
Red'g } Couplings.....	to..... in. at.....	\$
Inc'g }		
Union.....	in. at.....	\$
Meter.....	in. at.....	\$
Lbs. Br. Stone at.....		\$
Lbs. Sand at.....		\$
Bags Cement at.....		\$
Paving Brick } Mack } at.....		\$
} Red }		
} Asphalt }		
Lead Joints at.....		\$
Leadite Joints at.....		\$
4 Hrs. Foreman at.....	6.25	\$ 2.50
1 Hrs. Common Labor at.....	50	\$.50
25 Hrs. Common Labor at.....	4.08	\$ 10.25
Hrs. Mason at.....		\$
Hrs. Mason's Helper at.....		\$
Hrs. Compressor at.....		\$
Compensation Ins.....		\$ 35
Trucking.....		\$ 1.00
Builders' Use of Water.....		\$
Total		\$ 6.33

27-68 37

Labor and Material Report June 7 1926

31 Prospect St.

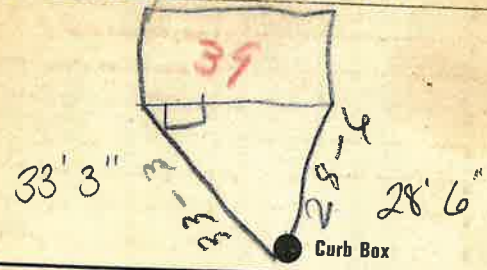

Main Elev. of Main at tap 4 1/2
 Gate at TAX ID# 303.17-15-10 Gate at

Curb Box

Old lot street

3/4" Copper
 28' to MAIN