

LABOR AND MATERIALS

1	Copper Lead	Connection	3/4"	\$	308
1	Curb	Cock Valve T.S. & V.	3/4 in.	\$	3.99
Same	Service box	Short 3 1/2 x 4 1/2		\$	
	Old returned	Long 4 1/2 x 5 1/2		\$	
		Buff or Rdway		\$	
26	3/4 in.	Copper G.I. C.I.	Pipe at 45'	\$	11.70
	Nipples	in. at		\$	
	Bushings	to in. at		\$	
	Red'g Inc'g	Coupl'gs to in. at		\$	
	Union	in. at		\$	
	Meter	in. at		\$	
	Lead Joints	at		\$	7069
	Compound Joints	at		\$	
5	Maintenance Foreman	1.937	\$	9.69	
	Hrs. Water Maint. Man	1 at	\$		
14	Hrs. Water Maint. Man	2 at 1.613	\$	22.58	
4	Hrs. Garage Foreman	1.481	\$	5.92	
2.5	Hrs. Labor	at 1.30	\$	32.50	
	Hrs. Compressor	at	\$		
	Compensation Ins.	at \$5.686 per C	\$	402	
	Trucking		\$	1.50	
	Pay't Patch		\$	20.16	
	Tap by Gissard & Co.		\$		
		10-22-23-56	\$		
	O'head		\$		
			\$	115.04	

Prospect

St. Pl. Ave. No. 45

Name of Owner

Funicelle

Labor and Mat'l. Report

Oct. 23 19 56

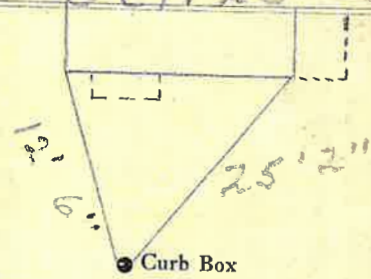

6" Main

Elev. of Main at tap 4'

Gate at • • Gate at

TAX ID # 303.17-6-17 10/22 45 & 47 are one

• Curb Box

3/4" copper
26' to main