

LABOR AND MATERIALS

1	Copper	{ Connection	3/4"	\$	3.04
1	Lead	{			
		{ Cock			
		{ Valve	3/4" in.	\$	3.54
		{ T.S. & V.			
1	Service box	{ Short 3 1/2 x 4 1/2		\$	4.70
	Old returned	{ Long 4 1/2 x 5 1/2			
		{ Buff or Rdway			
33	Ft. 3/4 in.	{ Copper	Pipe at 35	\$	11.55
		{ G.I.			
		{ C.I.			
	Nipples	in. at		\$	
	Bushings	to in. at		\$	
	Red'g	{ Coupl'gs	to in. at	\$	
	Ino'g				
	Union	in. at		\$	
	Meter	in. at		\$	
	Lead Joints	at		\$	
1	Compound Joints	at Fman.		\$	1.34
5	Hrs. Water Maint. Man-1	at 1.23		\$	6.15
7	Hrs. Water Maint. Man-2	at 1.13		\$	7.91
	Hrs. Labor	at		\$	
16	Hrs. Labor	at 1.02		\$	16.32
2	Hrs. Compressor	at 1.20		\$	2.40
	Compensation Ins. at \$ 2.66 per C.			\$	85
	Trucking			\$	1.00
	Pav't Patch			\$	20.20
				\$	
				\$	
	O'head			\$	
				\$	99.00

Tap made by Gifford  
Nov 20-1951

214-51

Prospect

St. # Ave. No. 77-79

Name of Owner  
Busch

Labor and Mat'l. Report Nov 20 1951

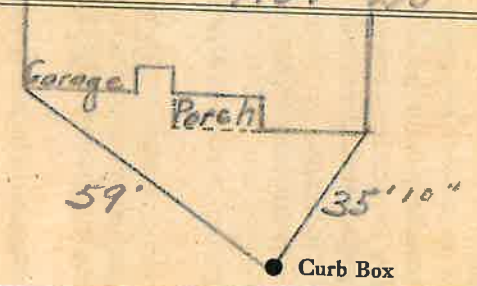

6" Main Elev. of Main at tap 4 1/2'

Gate at • Gate at

#79-TAX ID# 303.13-21-20

3/4" copper • Curb Box  
33' to MAIN