

Labor and Materials

Copper	Connection	$\frac{3}{4}$	\$	320
Lead		$\frac{3}{4}$		
Curb	Cock	$\frac{3}{4}$	\$	1.00
	Valve	$\frac{3}{4}$		
	Post & V.			
Service Box	Short 3" x 4"		\$	1.30
Old returned	Long 4" x 5"			
	Ball on Railway			
9 Ft.	Copper	$\frac{3}{4}$	\$	1.95
	Galv. Iron	$\frac{3}{4}$		
	Cast Iron			
	Pipe at			
	Nipples	in. at	\$	
	Bushings	to in. at	\$	
	Red'g	Couplings	to in. at	\$
	Inc'g			
	Union	in. at	\$	
	Meter	in. at	\$	
	Lbs. Br. Stone	at	\$	
	Lbs. Sand	at	\$	
	Bags Cement	at	\$	
	Paving Brick	Mack	at	\$
		Red		
		Asphalt		
	Lead Joints	at	\$	
	Leadite Joints	at	\$	
3	Hrs. Foreman	at	\$	1.87
6	Hrs. Common Labor	at	\$	3.50
6	Hrs. Common Labor	at	\$	2.43
	Hrs. Mason	at	\$	
	Hrs. Mason's Helper	at	\$	
	Hrs. Compressor	at	\$	
	Compensation Ins.	at	\$	1.19
1	Trucking	at	\$	1.00
	Builders' Use of Water	at	\$	
Total			\$	15.97

27-159 34

Labor and Material Report

Sept 14 1927

23 Prospect St

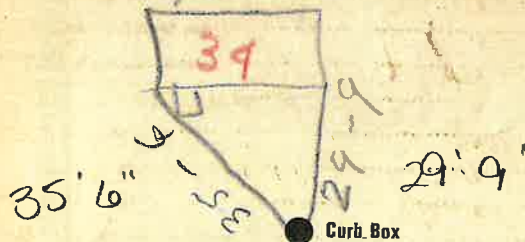

Main

Elev. of Main at tap

Gate at

Gate at

TAX 10 # 303.17.15-12

Curb Box

Old tap to be shut off

$\frac{3}{4}$ " Copper
9' to MAIN