

Prayn's Island

Reed

St. _____
Pl. _____
Ave. No. _____

Name of Owner

Rozell Plumbing

Labor and Mat'l. Report Sept 29, 1977

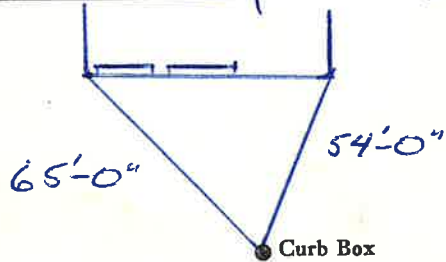

8" Main

Elev. of Main at tap 6'

Gate at ●

● Gate at

● Curb Box

shut off - 10/2/92

3/4" copper

24' to MAIN

LSM-5C-6-1-67

PRUYN'S ISLAND

REED

St. _____
Pl. _____
Ave. No. 1

Name of Owner

BYLSMA CORP (formerly ROZELL'S)

Labor and Mat'l. Report 1990

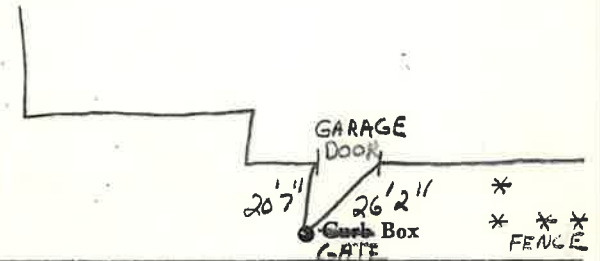

MURRAY ST

Main

Elev. of Main at tap _____

Gate at ●

● Gate at

2" copper ● Curb Box

TAP ON MURRAY ST.

LSM-5C-6-1-67

LABOR AND MATERIALS

1	Copper } Connection	<u>3/4</u>	\$	
	Lead }			
1	Curb } Cock		\$	
	} Valve	<u>3/4</u> in.		
	} T.S. & V.			
1	Service box	Short 3 1/2 x 4 1/2 Long 4 1/2 x 5 1/2 Buff or Rdway	\$	
	Old returned			
24	Ft. <u>3/4</u> in. } Copper } G. I. } C. I. } Pipe at			\$
	Nipples	in. at	\$	
	Bushings	to in. at	\$	
	Red'g } Coupl'gs	to in. at	\$	
	Inc'g }			
	Union	in. at	\$	
	Meter	in. at	\$	
	Lead Joints	at	\$	
	Compound Joints	at	\$	
	Maintenance Foreman		\$	
	Hrs. Water Maint. Man-1	at	\$	
	Hrs. Water Maint. Man-2	at	\$	
	Hrs. Garage Foreman	at	\$	
	Hrs. Labor	at	\$	
	Hrs. Compressor	at	\$	
	Compensation Ins.	at \$ per C	\$	
	Trucking		\$	
	Pav't Patch		\$	
			\$	
			\$	
			\$	
			\$	
			\$	
	O'head		\$	
			\$	

Tap Sept 29, 1977
Recher & Co.

LABOR AND MATERIALS

Copper } Connection	\$
Lead }	
Curb } Cock	in. \$
} Valve	
} T.S. & V.	
Service box	Short 3 1/2 x 4 1/2 Long 4 1/2 x 5 1/2
Old returned	
Ft. <u>2</u> in. } Copper } G. I. } C. I. } Pipe at	\$
Nipples	in. at \$
Bushings	to in. at \$
Red'g } Coupl'gs	to in. at \$
Inc'g }	
Union	in. at \$
Meter	in. at \$
	\$
Compound Joints	at \$
Maintenance Foreman	\$
Hrs. Water Maint. Man-1	at \$
Hrs. Water Maint. Man-2	at \$
Hrs. Garage Foreman	at \$
Hrs. Labor	at \$
Hrs. Compressor	at \$
	\$
Trucking	\$
Pav't Patch	\$
	\$
	\$
	\$
	\$

Reed

St.
~~Pl.~~

Ave. No.

Name of Owner ON Proyr's Island
West End Brewing Co.

Labor and Mat'l. Report Mar. 9 1964.

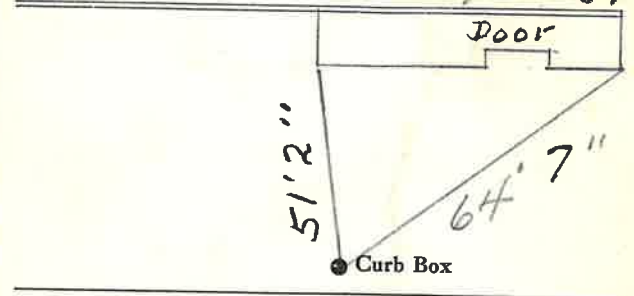

8" Main

Elev. of Main at tap 4 1/2'

Gate at ●

● Gate at

● Curb Box

3/4" COPPER
25' TO MAIN

LABOR AND MATERIALS

1	Copper	} Connection	3/4"	\$	_____
	Lead				
1	Curb	} Cock Valve T.S. & V.	} 3/4 in. Orisgal	\$	_____
1	Service box	} Short 3 1/2 x 4 1/2	} Long 4 1/2 x 5 1/2	\$	_____
	Old returned				
2.5	Ft. 3/4 in.	} Copper	} Pipe at	\$	_____
		} C.I.		\$	_____
	Nipples	in. at		\$	_____
	Bushings	to in. at		\$	_____
	Red'g	} Coupl'gs	to in. at	\$	_____
	Inc'g				
	Union	in. at		\$	_____
	Meter	in. at		\$	_____
	Lead Joints	at		\$	_____
	Compound Joints	at		\$	_____
	Maintenance Foreman			\$	_____
	Hrs. Water Maint. Man	1 at		\$	_____
	Hrs. Water Maint. Man	2 at		\$	_____
	Hrs. Garage Foreman	at		\$	_____
	Hrs. Labor	at		\$	_____
	Hrs. Compressor	at		\$	_____
	Compensation Ins.	at \$	per C	\$	_____
	Trucking			\$	_____
	Pav't Patch			\$	_____
	Tap by Gifford & Co.			\$	_____
	3-9-64.			\$	_____
	O'head			\$	_____
				\$	_____