

LABOR AND MATERIALS

1	Copper Lead	Connection	1 1/2	\$
1	Curb	Cock Valve T.S. & V.	1 1/2 in.	\$
1	Service box Old returned	Short 3 1/2 x 4 1/2 Long 4 1/2 x 5 1/2 Buff or Rdway		\$
11	Ft. 1/2 in.	Copper G.I. Pipe at		\$
1	Male Nipples	1/2 in. at	Adapter	\$
	Bushings	to in. at		\$
	Red'g Inc'g	Coupl'gs to in. at		\$
	Union	in. at		\$
1	Meter	1 1/2 in. at		\$
	Lead Joints	at		\$
	Compound Joints	at		\$
	Maintenance Foreman			\$
	Hrs. Water Maint. Man-1	at		\$
	Hrs. Water Maint. Man-2	at		\$
	Hrs. Garage Foreman	at		\$
	Hrs. Labor	at		\$
	Hrs. Compressor	at		\$
	Compensation Ins.	at \$ per C		\$
	Trucking			\$
	Pav't Patch			\$
	Tap by Gifford & Co			\$
	11-18-58			\$
	O'head			\$

✓ Pruyn's Island

St. \_\_\_\_\_  
Pl. \_\_\_\_\_  
Ave. No. \_\_\_\_\_

Name of Owner:  
Union-Camp Paper Co.  
Measured in  
Labor and Mat'l. Report Dec. 8, 1958

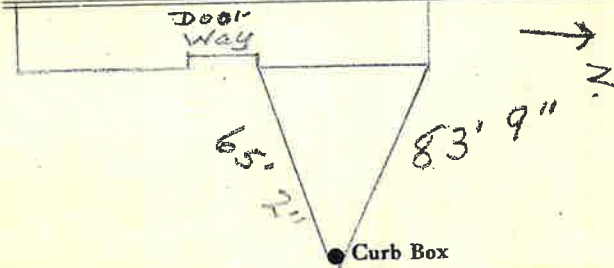

6" Main Elev. of Main at tap 5'

Gate at • Gate at

11' to MAIN

• Curb Box  
1 1/2" Tap, copper  
old Bldg.  
1958