

LABOR AND MATERIALS

1 Copper } Connection ^{3/4"} \$ _____
 1 Lead }
 1 Curb } Cock } 3/4 in. \$ _____
 } Valve }
 } T.S. & V. }
 1 Service box { Short 3 1/2 x 4 1/2 }
 - Old returned { Long 4 1/2 x 5 1/2 }
 { Buff or Rdway } \$ _____
 12 Ft. ^{3/4} in. { Copper } Pipe at \$ _____
 { G.I. }
 { C.I. }
 Nipples in. at \$ _____
 Bushings to in. at \$ _____
 Red'g }
 Inc'g } Coupl'gs to in. at \$ _____
 Union in. at \$ _____
 Meter in. at \$ _____
 Lead Joints at \$ _____
 Compound Joints at \$ _____
 Maintenance Foreman \$ _____
 Hrs. Water Maint. Man-1 at \$ _____
 Hrs. Water Maint. Man-2 at \$ _____
 Hrs. Garage Foreman at \$ _____
 Hrs. Labor at \$ _____
 Hrs. Compressor at \$ _____
 Compensation Ins. at \$ _____ per C \$ _____
 Trucking \$ _____
 Pav't Patch \$ _____
 Tap by Gifford \$ _____
 10-21-57 \$ _____
 O'head \$ _____
 \$ _____

Pulver

St. _____
Pl. _____
Ave. No. 1

Name of Owner

Harold Greenwood

Labor and Mat'l. Report

Oct. 21 1957

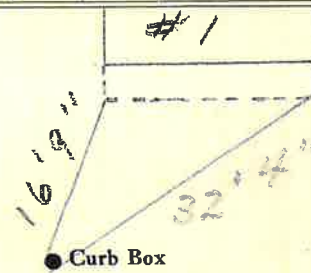

6" Main

Elev. of Main at tap 5'

Gate at ●

● Gate at

TAX ID # 302.15-14-9

● Curb Box

3/4" copper
12' to main