

LABOR AND MATERIALS

1	Copper	Connection	1"	\$
1	Lead	Cock		
1	Curb	Valve	1 in. Oriseat	\$
		Fr. Dr. & V.		
1	Service box	Short 3 1/2 x 4 1/2		
	Old returned	Long 4 1/2 x 5 1/2		
		Buff. or Rdway		\$
28	Ft. 1 in.	Copper	Pipe at	\$
		G.I.		
		C.I.		
	Nipples	in. at		\$
	Bushings	to in. at		\$
	Red'g			
	Inc'g	Coupl'gs to in. at		\$
	Union	in. at		\$
	Meter	in. at		\$
	Lead Joints	at		\$
	Compound Joints	at		\$
	Maintenance Foreman			\$
	Hrs. Water Maint. Man-1	at		\$
	Hrs. Water Maint. Man-2	at		\$
	Hrs. Garage Foreman	at		\$
	Hrs. Labor	at		\$
	Hrs. Compressor	at		\$
	Compensation Ins. at \$	per C		\$
	Trucking			\$
	Pav't Patch			\$
	Tap by Giggard & Co.			\$
	7-1-64.			\$
	O'head			\$

TAX ID# 302.19-23-3

St. Ave. No. 15

Quade
Name of Owner City School Dist.
Administration Bldg.

Labor and Mat'l. Report July 1 1964

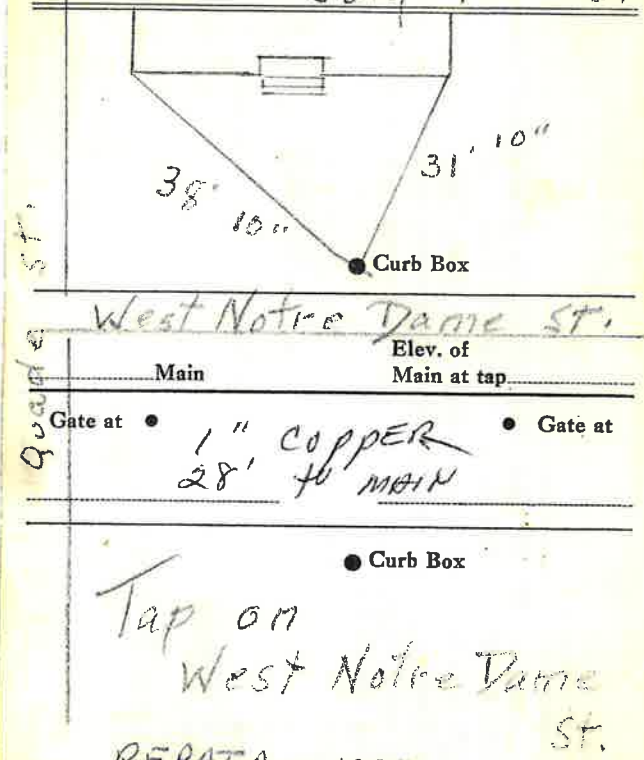

REPAIR - 1999

LSM-5C-3-10-61

COPPER LOOPED NEAR ROAD SURFACE