

Labor and Materials

Copper	Connection	3	\$ 2.70
Lead		3	
Curb	Cock Valve	3	\$ 2.34
	2" V.	3	
Service Box	Short 3/4x1 1/2		\$ 1.55
Old removed	Long 1 1/2x5 1/2		
	Buff. or Rdway		
8	Ft. in.	3	\$ 2.70
	Copper Galv. Iron Pipe at Cast Iron		
	Nipples		\$
	Bushings		\$
	Red'g Inc'g Couplings		\$
	Union		\$
	Meter		\$
	Lbs. Br. Stone at		\$
	Lbs. Sand at		\$
	Bags Cement at		\$
	Paving Brick		\$
	Lead Joints at		\$
	Leadite Joints at		\$
3	Hrs. Foreman at		\$ 1.88
10	Hrs. Common Labor at		\$ 4.50
	Hrs. Common Labor at		\$
	Hrs. Mason at		\$
	Hrs. Mason's Helper at		\$
	Hrs. Compressor at		\$
	Compensation Ins		\$ 20
	Trucking		\$ 1.-
	Builders' Use of Water	Patch	\$ 5.-
Total \$			21.92

Raymond Ave.

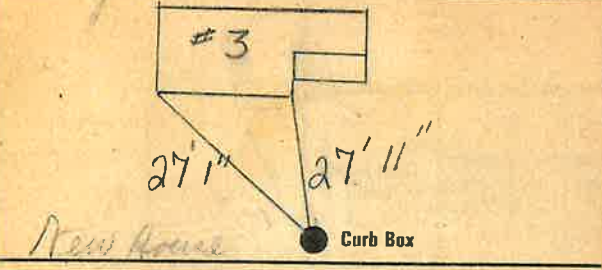

4" Main Elev of Main at tap 4 1/2

Gate at 10 # 303.9 - 10 - 12 Gate at



3/4" COPPER
8' to MAIN