

LABOR AND MATERIALS

1 Copper } Connection <sup>3/4"</sup> \$ \_\_\_\_\_  
 Lead }  
 1 Curb } Cock } 3/4 in. \$ \_\_\_\_\_  
 Valve }  
 T.S. & V. }  
 1 Service box } { Short 3 1/2 x 4 1/2 }  
 Old returned } { Long 4 1/2 x 5 1/2 }  
 } { Buff or Rdway } \$ \_\_\_\_\_  
 27 <sup>3/4</sup> Ft. in. } { Copper } Pipe at \$ \_\_\_\_\_  
 } { G.I. }  
 } { C.I. }  
 Nipples in. at \$ \_\_\_\_\_  
 Bushings to in. at \$ \_\_\_\_\_  
 Red'g }  
 Inc'g } Coupl'gs. to in. at \$ \_\_\_\_\_  
 Union in. at \$ \_\_\_\_\_  
 Meter in. at \$ \_\_\_\_\_  
 Lead Joints at \$ \_\_\_\_\_  
 Compound Joints at \$ \_\_\_\_\_  
 Maintenance Foreman \$ \_\_\_\_\_  
 Hrs. Water Maint. Man-1 at \$ \_\_\_\_\_  
 Hrs. Water Maint. Man-2 at \$ \_\_\_\_\_  
 Hrs. Garage Foreman at \$ \_\_\_\_\_  
 Hrs. Labor- at \$ \_\_\_\_\_  
 Hrs. Compressor at \$ \_\_\_\_\_  
 Compensation Ins. at \$ \_\_\_\_\_ per C \$ \_\_\_\_\_  
 Trucking \$ \_\_\_\_\_  
 Pav't Patch \$ \_\_\_\_\_  
 Tap by Giffordt \$ \_\_\_\_\_  
 Co 12-9-57 \$ \_\_\_\_\_  
 O'head \$ \_\_\_\_\_  
 \$ \_\_\_\_\_

Reservoir <sup>Standard</sup> Pl. Ave. No. 11

Name of Owner \_\_\_\_\_

Labor and Mat'l. Report Dec. 9 19 57

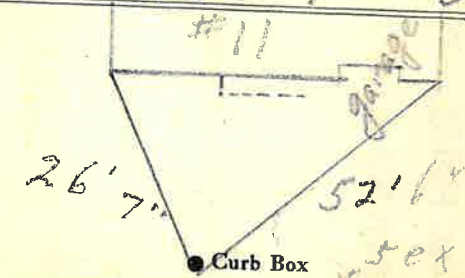

TRANSITE  
 6 Main Elev. of Main at tap 5 1/2'

Gate at • Gate at •

TAX ID # 302.17-4-8

• Curb Box