

266 RIDGE

ST  
Pl.  
Ave. No.

Name of Owner

TAX ID # 302.12-15-3

Labor and Mat'l. Report 19

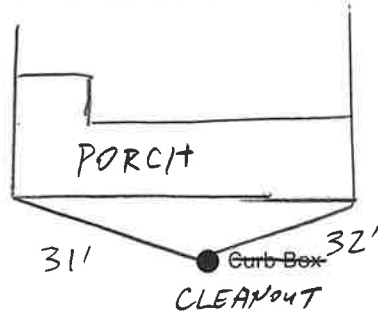

\_\_\_\_\_ Main

Elev. of  
Main at tap \_\_\_\_\_

Gate at ●

● Gate at \_\_\_\_\_

● Curb Box

**RECEIVED**

**JAN 15 2018**

**City of Glens Falls  
W.W.T.P.**

33-84 266

Labor and Material Report

Nov 4 1933

210 Ridge St

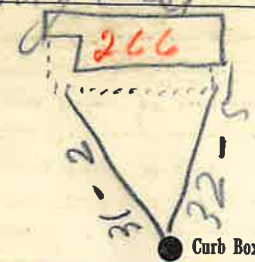

6- Main

Elev. of  
Main at tap 52

Gate at ●

● Gate at \_\_\_\_\_

● Curb Box

old taps shut off at main

Note: New Copper  
from box to main -  
Dec. '90

P.K. [Signature]  
3/4" - 28' copper

## LABOR AND MATERIALS

Copper	}	Connection			\$		
Lead							
Curb	}	Cock	} in.		\$		
		Valve					
		T.S. & V.					
Service box	{	Short 3-1/2 x 4-1/2	}		\$		
Old returned		Long 4-1/2 x 5-1/2					
Ft. _____	{	Copper	} Pipe at		\$		
_____ in.		G.I.					
		C.I.					
Nipples _____		in. at _____			\$		
Bushings _____		to _____ in. at _____			\$		
Red'g _____					\$		
Inc'g _____					\$		
Union _____		in. at _____			\$		
Meter _____		in. at _____			\$		
_____					\$		
Compound Joints at _____					\$		
Maintenance Foreman _____					\$		
Hrs. Water Maint. Man - 1 at _____					\$		
Hrs. Water Maint. Man - 2 at _____					\$		
Hrs. Garage Foreman _____ at _____					\$		
Hrs. Labor _____ at _____					\$		
Hrs. Compressor at _____					\$		
_____					\$		
Trucking _____					\$		
Pav't Patch _____					\$		
_____					\$		
_____					\$		
_____					\$		
_____					\$		

## Labor and Materials

	}	Connection.....			\$		
1. <del>Lead</del>							1.33
.....	}	Cock	} .....	in	\$		
.....		Valve					1.58
.....		T.S. & V.					
.....	}	Short 2 1/2 x 4 1/2	}		\$		
.....		Long 4 1/2 x 5 1/2					1.36
.....	}	Buff. or Rdway	}		\$		
.....		Old returned					
2. 8 Ft. <sup>2</sup> / <sub>4</sub>	}	Copper	} Pipe at		\$	2.66	
.....		Galv. Iron					
.....		Cast Iron					
.....		in. at			\$		
.....		Bushings	.....to	.....in. at	\$		
.....	}	Red'g	} Couplings.....to	.....in.at	\$		
.....		Inc'g					
.....		Union.....	in. at		\$		
.....		Meter.....	in. at		\$		
.....					\$		
.....		Lbs. Br. Stone at			\$		
.....		Lbs. Sand at			\$		
.....		Bags Cement at			\$		
.....	}	Mack	} at		\$		
.....		Red					
.....		Asphalt					
.....		Lead Joints at			\$		
.....		Leadite Joints at			\$		
.....		Hrs. Foreman at			\$	3.13	
.....		Hrs. Common Labor at	.....50		\$	1.50	
.....		Hrs. Common Labor at	.....45		\$	6.30	
.....		Hrs. Mason at			\$		
.....		Hrs. Masons Helper at			\$		
.....		Hrs. Compressor at			\$		
.....		Compensation Ins			\$	.34	
.....		Trucking			\$	1.00	
.....		Builders Use of Water	Patch		\$	5.00	
Total					\$	24.20	