

LABOR AND MATERIALS

_____	Copper } Connection _____	\$ _____
_____	Lead } _____	\$ _____
_____	Curb } Cock _____	\$ _____
_____	Valve } _____ in.	\$ _____
_____	T.S. & V. } _____	\$ _____
_____	Service box { Short 3-1/2 x 4-1/2 }	\$ _____
_____	Old returned { Long 4-1/2 x 5-1/2 }	\$ _____
_____	Ft. _____ in. { Copper } Pipe at _____	\$ _____
_____	{ G.I. }	\$ _____
_____	{ C.I. }	\$ _____
_____	Nipples _____ in. at _____	\$ _____
_____	Bushings _____ to _____ in. at _____	\$ _____
_____	Red'g _____	\$ _____
_____	Inc'g _____	\$ _____
_____	Union _____ in. at _____	\$ _____
_____	Meter _____ in. at _____	\$ _____
_____	_____	\$ _____
_____	Compound Joints at _____	\$ _____
_____	Maintenance Foreman _____	\$ _____
_____	Hrs. Water Maint. Man - 1 at _____	\$ _____
_____	Hrs. Water Maint. Man - 2 at _____	\$ _____
_____	Hrs. Garage Foreman _____ at _____	\$ _____
_____	Hrs. Labor _____ at _____	\$ _____
_____	Hrs. Compressor at _____	\$ _____
_____	_____	\$ _____
_____	Trucking _____	\$ _____
_____	Pav't Patch _____	\$ _____
_____	_____	\$ _____
_____	_____	\$ _____
_____	_____	\$ _____
_____	_____	\$ _____
_____	_____	\$ _____

21 RIDGE

PI. Ave. No. _____

Name of Owner _____

Labor and Mat'l. Report 19

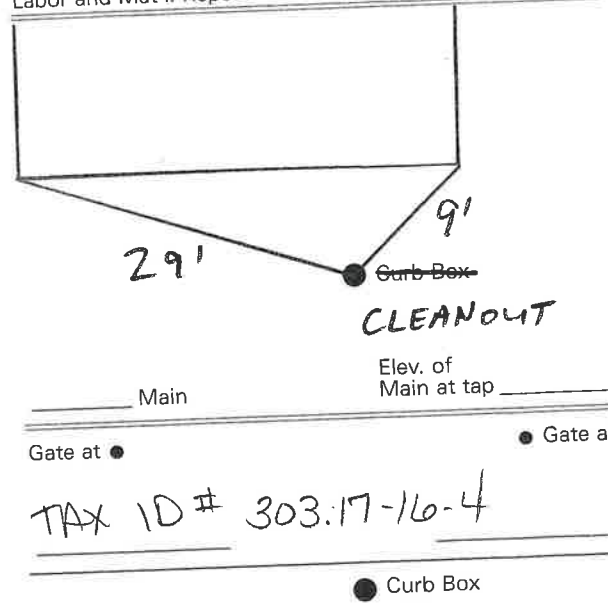

TAX ID # 303.17-16-4

RECEIVED

JAN 15 2018

**City of Glens Falls
W.W.T.P.**

LABOR AND MATERIALS

Mueller 10" x 6" poured

1	Copper Lead	Connection	10" x 6"	\$
1	Curb	Cook-Valve T.S. & V.	6 in.	\$
1	Service box	Short 3 1/2 x 4 1/2 Long 4 1/2 x 5 1/2 Buff or Rdway		\$
	Old returned			
20 1/2'	6 in.	Copper G.I. C.I.	Pipe at	\$
	Nipples	in.	at	\$
	Bushings	to	in. at	\$
	Red'g Inc'g	Coupl'gs	to in. at	\$
	Union	in.	at	\$
	Meter	in.	at	\$
	Lead Joints	at		\$
	Compound Joints	at		\$
	Maintenance Foreman			\$
	Hrs. Water Maint. Man	1 at		\$
	Hrs. Water Maint. Man	2 at		\$
	Hrs. Garage Foreman	at		\$
	Hrs. Labor	at		\$
	Hrs. Compressor	at		\$
	Compensation Ins.	at \$	per C	\$
	Trucking			\$
	Pav't Patch			\$
	Tap by Lareau & Co.			\$
	5-17-67.			\$
	O'head			\$
				\$

Ridge

St. Pt. 21-23
Ave. No.

Name of Owner

Fashion Shop.

Labor and Mat'l. Report May 17 19 67

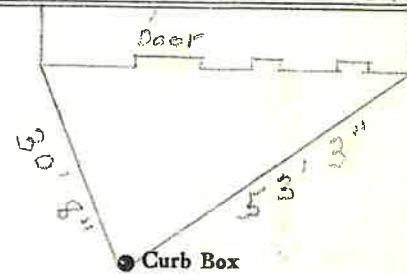

10" Main

Elev. of Main at tap 5'

Gate at ●

● Gate at

● Curb Box

6" Tap

Sprinkler System.

20 1/2' to MAIN

LABOR AND MATERIALS

1	Copper	} Connection	3/4"	\$	
1	Lead				
1	Curb	} Cock	3/4" in.	\$	
					} Valve
1	Service box	} Short 3 1/2 x 4 1/2	Same,	\$	
	Old returned				Long 4 1/2 x 5 1/2
		Buff or Rdway			
10	Ft.	} Copper	3/4" in.	\$	
					G.I.
		C.I.	Pipe at		
	Nipples	in. at		\$	
	Bushings	to in. at		\$	
1	Red'g	} Coupl'gs	1 to 3/4" in.	\$	
	Ine'g				
	Union	in. at	Brass,	\$	
	Meter	in. at		\$	
	Lead Joints	at		\$	
	Compound Joints	at		\$	
	Maintenance Foreman			\$	
	Hrs. Water Maint. Man	1 at		\$	
	Hrs. Water Maint. Man	2 at		\$	
	Hrs. Garage Foreman	at		\$	
	Hrs. Labor	at		\$	
	Hrs. Compressor	at		\$	
	Compensation Ins.	at \$ per C		\$	
	Trucking			\$	
	Pav't Patch			\$	
	Tap by Gifford & Co.			\$	
	10-17-63.			\$	
	O'head			\$	

Ridge
 St. Pl. 21-23
 Ave. No.

Name of Owner Wilmarth's Store
 Don Hallenbeck

Labor and Mat'l. Report Oct. 17 19 63

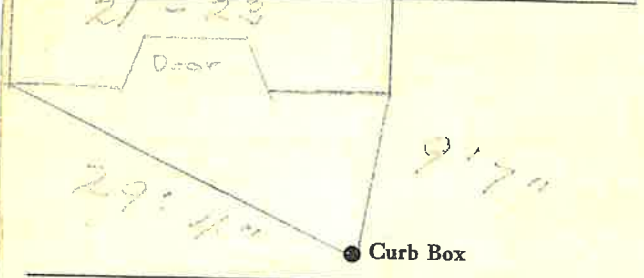

10" Main Elev. of Main at tap 5'

Gate at • Gate at

• Curb Box

3/4" Tap. Copper

10' to MAIN