

LABOR AND MATERIALS

3/4	Copper	Connection		\$	
3/4	Lead			\$	
3/4	Curb	Cock Valve T.S. & V.	in.	\$	
3/4	Service box	Short 3-1/2 x 4-1/2		\$	
	Old returned	Long 4-1/2 x 5-1/2		\$	
23	Ft.	3/4 in. Copper G.I. C.I.	Pipe at	\$	
	Nipples		in. at	\$	
	Bushings		to in. at	\$	
	Red'g				
	Inc'g				
	Union		in. at	\$	
	Meter		in. at	\$	
	Compound Joints		at	\$	
	Maintenance Foreman			\$	
	Hrs. Water Maint. Man - 1		at	\$	
	Hrs. Water Maint. Man - 2		at	\$	
	Hrs. Garage Foreman		at	\$	
	Hrs. Labor		at	\$	
	Hrs. Compressor		at	\$	
	Trucking			\$	
	Pav't Patch			\$	
				\$	
				\$	
				\$	
				\$	
				\$	

RIDGE St. Ave. No. 162
 Name of Owner
 TAX ID# - 302.20-11-11

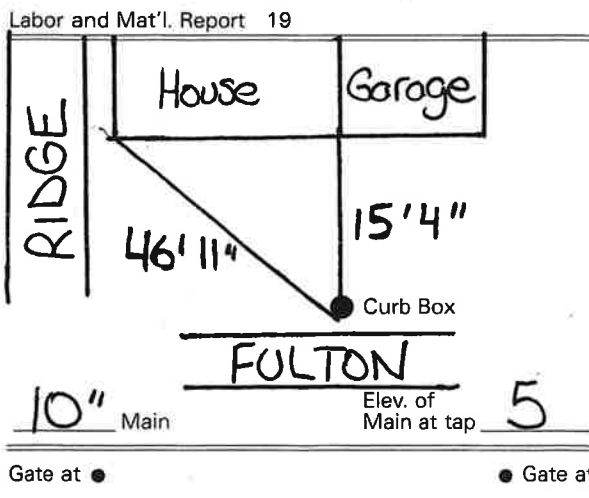

TAP ON FULTON ST. SIDE
 23 3/4 FT. TO THE MAIN