

LABOR AND MATERIALS

1	Copper Lead	Connection	1 1/2"	\$ 1245
1	Curb	Cock Valve T.S. & V.	1 1/2 in.	\$
1	Service box	Short 3 1/2 x 4 1/2		
20	Old returned	Long 4 1/2 x 5 1/2		
		Buff or Rdway		\$ 1109
24	Ft. 1 1/2 in.	Copper Pipe at		\$
		G.I.		\$
		C.I.		\$
	Nipples	in. at		\$
1	Bushings	1/2 to 1/4 in. at		\$
1	Red'g Inc'g	Brass Coupl'gs 1 1/2 to 1 1/2 in. at		\$
	Union	Elbow in. at		\$
1	Meter	1 1/2 in. at	Male Adapter	\$ 1.75
	Lead Joints at			\$
	Compound Joints at			\$
	Maintenance Foreman			\$
	Hrs. Water Maint. Man	1 at		\$ 6.45
11	Hrs. Water Maint. Man	2 at	1.615	\$ 23.70
16	Hrs. Garage Foreman	at	1.491	\$ 41.60
32	Hrs. Labor	at	1.30	\$
	Hrs. Compressor at			\$
	Compensation Ins. at	\$ 5.686 per C.		\$ 7.08
	Trucking			\$ 1.50
	Pav't Patch			\$ 9.45
	Tap by Giggard,			\$
	Miller at			\$
	8-1-56			\$
	O'head			\$

Ridge

St. Ave. No. 128

Name of Owner  
Empire Super. M'kt.

Labor and Mat'l. Report AUG. 1 19 56  
Market

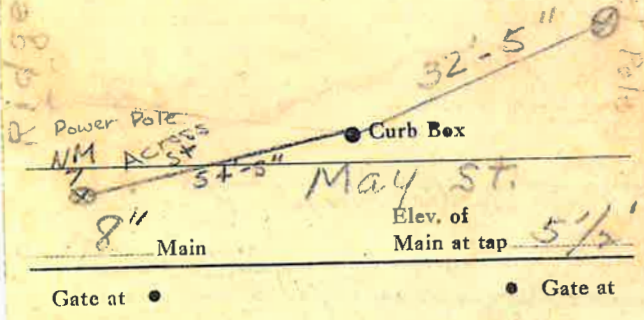

1 1/2" copper Curb Box  
 20' to MAIN  
 Re measured 6-25-75