

**LABOR AND MATERIALS**

\_\_\_\_\_ Copper } Connection \_\_\_\_\_ \$ \_\_\_\_\_  
 \_\_\_\_\_ Lead }  
 \_\_\_\_\_ Curb } Cock \_\_\_\_\_ in. \_\_\_\_\_ \$ \_\_\_\_\_  
 \_\_\_\_\_ Valve }  
 \_\_\_\_\_ T.S. & V. }  
 \_\_\_\_\_ Service box { Short 3-1/2 x 4-1/2 } \_\_\_\_\_ \$ \_\_\_\_\_  
 \_\_\_\_\_ Old returned { Long 4-1/2 x 5-1/2 }  
 \_\_\_\_\_ Ft. \_\_\_\_\_ in. { Copper } Pipe at \_\_\_\_\_ \$ \_\_\_\_\_  
 \_\_\_\_\_ G.I.  
 \_\_\_\_\_ C.I.  
 \_\_\_\_\_ Nipples \_\_\_\_\_ in. at \_\_\_\_\_ \$ \_\_\_\_\_  
 \_\_\_\_\_ Bushings \_\_\_\_\_ to \_\_\_\_\_ in. at \_\_\_\_\_ \$ \_\_\_\_\_  
 \_\_\_\_\_ Red'g \_\_\_\_\_  
 \_\_\_\_\_ Inc'g \_\_\_\_\_  
 \_\_\_\_\_ Union \_\_\_\_\_ in. at \_\_\_\_\_ \$ \_\_\_\_\_  
 \_\_\_\_\_ Meter \_\_\_\_\_ in. at \_\_\_\_\_ \$ \_\_\_\_\_  
 \_\_\_\_\_ \$ \_\_\_\_\_  
 \_\_\_\_\_ Compound Joints at \_\_\_\_\_ \$ \_\_\_\_\_  
 \_\_\_\_\_ Maintenance Foreman \_\_\_\_\_ \$ \_\_\_\_\_  
 \_\_\_\_\_ Hrs. Water Maint. Man - 1 at \_\_\_\_\_ \$ \_\_\_\_\_  
 \_\_\_\_\_ Hrs. Water Maint. Man - 2 at \_\_\_\_\_ \$ \_\_\_\_\_  
 \_\_\_\_\_ Hrs. Garage Foreman \_\_\_\_\_ at \_\_\_\_\_ \$ \_\_\_\_\_  
 \_\_\_\_\_ Hrs. Labor \_\_\_\_\_ at \_\_\_\_\_ \$ \_\_\_\_\_  
 \_\_\_\_\_ Hrs. Compressor at \_\_\_\_\_ \$ \_\_\_\_\_  
 \_\_\_\_\_ \$ \_\_\_\_\_  
 \_\_\_\_\_ Trucking \_\_\_\_\_ \$ \_\_\_\_\_  
 \_\_\_\_\_ Pav't Patch \_\_\_\_\_ \$ \_\_\_\_\_  
 \_\_\_\_\_ \$ \_\_\_\_\_  
 \_\_\_\_\_ \$ \_\_\_\_\_  
 \_\_\_\_\_ \$ \_\_\_\_\_  
 \_\_\_\_\_ \$ \_\_\_\_\_  
 \_\_\_\_\_ \$ \_\_\_\_\_

FIREHOUSE St. \_\_\_\_\_  
 Ave. No. 134  
 Name of Owner RIDGE STREET

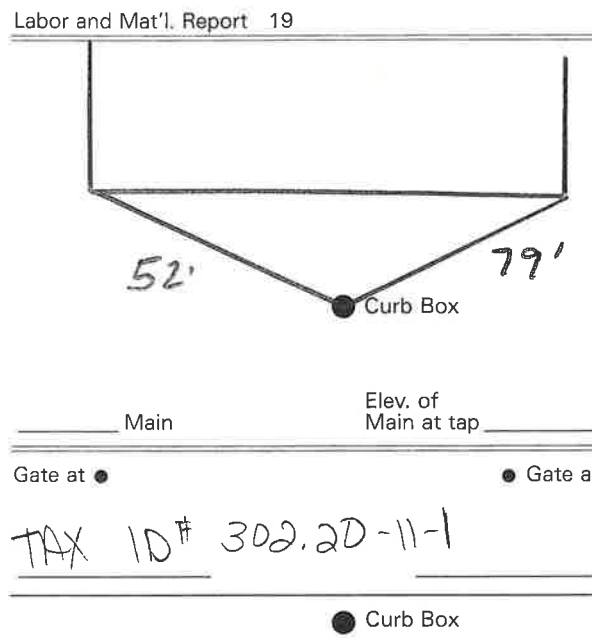

**RECEIVED**  
**JAN 15 2018**  
 City of Glens Falls  
 W.W.T.P.

LABOR AND MATERIALS

Copper Lead	{ Connection 1" }	\$ 7.40
Curb	{ Cock Valve T.S. & V. } 1" in.	\$ 9.47
Service Box	{ Short 3 1/2 x 4 1/2 } { Old returned Long 4 1/2 x 5 1/2 } Buff. or Rdway	\$ 1.75
34 Ft. 1" in.	{ Copper Galv Iron Cast Iron } Pipe at	\$ 9.18
Nipples	in. at	\$
Bushings	to in. at	\$
Red'g Inc'g	{ Couplings to in. at	\$
Union	in. at	\$
Meter	in. at	\$
Lead Joints	at	\$
Leadite Joints	at	\$
Hrs. Foreman	at	\$
2 Hrs. Chauffeur	at 62 hr	\$ 1.25
3 Hrs. Tapper	at 9	\$ 1.88
3 Hrs. Labor	at 45	\$ 1.35
Hrs. Labor	at	\$
1/2 Hrs. Compressor	at 87 hr	\$ 1.31
Compensation Ins.		\$ .14
Trucking		\$ .50
Builders Use of Water	Patch	\$ 4.50
Trophy Hoistell		\$
		\$
		\$
		\$
		\$
		\$ 38.73

161 - 1938

St. 134-138

Pl.

Ave. No. 96

Name of Owner (Fire Dept)

Labor and Mat'l. Report

19

134-138

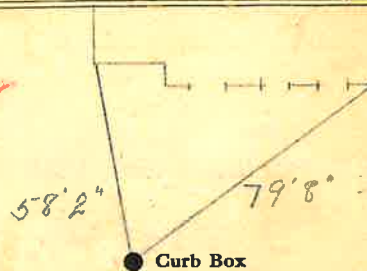

8" Main

Elev. of

Main at tap 5

Gate at ●

● Gate at

● Curb Box

1" Copper  
34' to main

New Tap

LABOR AND MATERIALS

1	Copper Lead	Connection $\frac{3}{4}$	\$ 1.23
1	Curb	Cock Valve T. S. & V. $\frac{3}{4}$ in.	\$ 1.68
1	Service Box	Short $3\frac{1}{2} \times 4\frac{1}{2}$	\$ 1.75
	Old returned	Long $4\frac{1}{2} \times 5\frac{1}{2}$	
		Buff. or Rdway	
	96 Ft. $\frac{3}{4}$ in.	Copper Galv. Iron Cast Iron	Pipe at \$ 14.40
	Nipples	in. at	\$
	Bushings	to in. at	\$
	Red'g Inc'g	Couplings to in. at	\$
	Union	in. at	\$
	Meter	in. at	\$
	Lead Joints	at	\$
	Leadite Joints	at	\$
	Hrs. Foreman	at	\$
2	Hrs. Chauffeur	at $62\frac{1}{2}$	\$ 1.25
5	Hrs. Tapper	at 7	\$ 3.12
5	Hrs. Labor	at 75	\$ 2.25
	Hrs. Labor	at	\$ 21
1 1/2	Hrs. Compressor	at $87\frac{1}{2}$	\$ 1.32
	Compensation Ins.		\$
	Trucking		\$ 50
	Builders Use of Water	Kitch	\$ 4.50
			\$
			\$
			\$
			\$
			\$ 32.21

*Handwritten notes in red ink:*  
 Total 11.25  
 10.00  
 1.25

St.

PT.

Ave. No. 96

Ridge

Name of Owner

Glens Falls Fire Dept.

Labor and Mat'l. Report

Nov 10 1928

This tap is for Pressure Gage

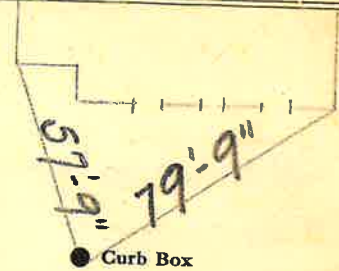

● Curb Box

8 Main

Elev. of

Main at tap 5

Gate at ●

● Gate at

● Curb Box

$\frac{3}{4}$ " Copper

96'

New Tap for Pressure Gage