

Copy 158

Ridge
Name of Owner

St. Pl. Ave. No. 112

Dudley
Found to be Copper 19-16-70
Labor and Mat'l. Report July 10 1925

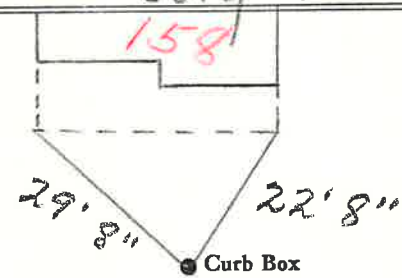

6" Main Elev. of Main at tap 5'
Gate at • Gate at •

• Curb Box

3/4" copper
27' to main

LSM-5C-6-1-67

158 RIDGE

St. Pl. Ave. No.

Name of Owner
TAX ID # 302.20-11-9

Labor and Mat'l. Report 19

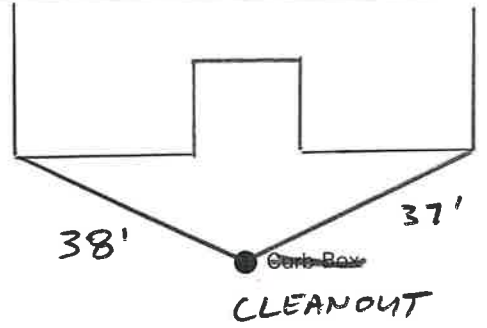

Main Elev. of Main at tap
Gate at • Gate at •

• Curb Box

RECEIVED

JAN 15 2018

City of Glens Falls
W.W.T.P.

LABOR AND MATERIALS

1 Copper } Connection 3/4" \$ _____
 Lead }
 1 Curb } Cock } 3/4 in. \$ _____
 } Valve }
 } T.S. & V. }
 1 Service box { Short $3\frac{1}{2} \times 4\frac{1}{2}$ }
 Old returned { Long $4\frac{1}{2} \times 5\frac{1}{2}$ } \$ _____
 { Buff or Rdway }
 27 Ft. 3/4 in. { Copper } Pipe at \$ _____
 { G.I. }
 { C.I. }
 Nipples _____ in. at \$ _____
 Bushings _____ to _____ in. at \$ _____
 Red'g }
 Inc'g } Coupl'gs _____ to _____ in. at \$ _____
 Union _____ in. at \$ _____
 Meter _____ in. at \$ _____
 Lead Joints at \$ _____
 Compound Joints at \$ _____
 Maintenance Foreman _____ \$ _____
 Hrs. Water Maint. Man—1 at \$ _____
 Hrs. Water Maint. Man—2 at \$ _____
 Hrs. Garage Foreman _____ at \$ _____
 Hrs. Labor— _____ at \$ _____
 Hrs. Compressor at \$ _____
 Compensation Ins. at \$ _____ per C \$ _____
 Trucking _____ \$ _____
 Pav't Patch _____ \$ _____
 Due to leak at main
 dug up & found to be
 copper
 O'head 9-16-10. \$ _____
 \$ _____

LABOR AND MATERIALS

Copper } Connection _____ \$ _____
 Lead }
 Curb } Cock } _____ in. \$ _____
 } Valve }
 } T.S. & V. }
 Service box { Short $3-1/2 \times 4-1/2$ } \$ _____
 Old returned { Long $4-1/2 \times 5-1/2$ }
 Ft. _____ in. { Copper } Pipe at \$ _____
 { G.I. }
 { C.I. }
 Nipples _____ in. at \$ _____
 Bushings _____ to _____ in. at \$ _____
 Red'g _____
 Inc'g _____
 Union _____ in. at \$ _____
 Meter _____ in. at \$ _____
 _____ \$ _____
 Compound Joints at \$ _____
 Maintenance Foreman _____ \$ _____
 Hrs. Water Maint. Man - 1 at \$ _____
 Hrs. Water Maint. Man - 2 at \$ _____
 Hrs. Garage Foreman _____ at \$ _____
 Hrs. Labor _____ at \$ _____
 Hrs. Compressor at \$ _____
 _____ \$ _____
 Trucking _____ \$ _____
 Pav't Patch _____ \$ _____
 _____ \$ _____
 _____ \$ _____
 _____ \$ _____
 _____ \$ _____
 _____ \$ _____