

Labor and Materials

1	Copper	Connection.....	?	\$ 1.48
1	Lead	.....		
1	Curb	{ Cock Valve Box }	?	\$ 1.79
1	Service Box	{ Short 3 1/2 x 4 1/2 Long 4 1/2 x 6 1/2 Buff. or Redway }		\$ 1.18
11	Ft. .... in.	{ Copper Galv. Iron Cast Iron }	?	\$ 1.98
	Nipples	..... in. at		\$
	Bushings	..... to ..... in. at		\$
	Red'g Inc'g	{ Couplings..... to ..... in. at		\$
	Union	..... in. at		\$
	Meter	..... in. at		\$
	Lbs. Br. Stone	at		\$
	Lbs. Sand	at		\$
	Bags Cement	at		\$
	Paving Brick	{ Mack Red Asphalt }	at	\$
	Lead Joints	at		\$
	Leadite Joints	at		\$
3	Hrs. Foreman	at		\$ 1.88
9	Hrs. Common Labor	at		\$ 3.60
	Hrs. Common Labor	at		\$
	Hrs. Mason	at		\$
	Hrs. Masons Helper	at		\$
	Hrs. Compressor	at		\$
	Compensation Ins			\$ 1.7
	Trucking			\$ 1. -
	Builders Use of Water	Rate		\$ 5. -

Total \$ 18.08

5 36 229 Labor and Material Report May 4 1922

174 Ridge St

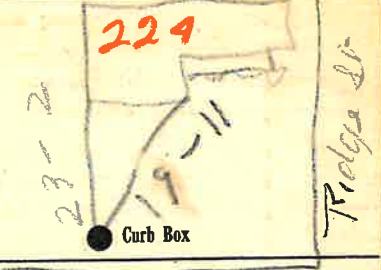

4 Main Elev. of Main at tap 5 1/2

Gate at TAX ID# 302.12-27-1 Gate at

● Curb Box

old Tap shut off  
Tap made on Hoyt Ave  
3/4" - 11' copper

ETB