

LABOR AND MATERIALS

Copper	} Connection	_____	\$ _____	
Lead				
Curb	} Cock } Valve } T. S. & V.	_____ in.	\$ _____	
Service box		} Short 3½ x 4½ } Long 4½ x 5½		
Old returned			} Buff or Rdway	\$ _____
Ft. _____ in.	} Copper } G. I. } C. I.	Pipe at _____	\$ _____	
Nipples _____ in.		at _____	\$ _____	
Bushings _____ to _____ in.		at _____	\$ _____	
Red'g } Inc'g }	} Coupl'gs	_____ to _____ in.	\$ _____	
Union _____ in.		at _____	\$ _____	
Meter _____ in.	at _____	\$ _____		
Lead Joints	at _____	\$ _____		
Compound Joints	at _____	\$ _____		
Maintenance Foreman	_____	\$ _____		
Hrs. Water Maint. Man—1	at _____	\$ _____		
Hrs. Water Maint. Man—2	at _____	\$ _____		
Hrs. Garage Foreman	at _____	\$ _____		
Hrs. Labor—	at _____	\$ _____		
Hrs. Compressor	at _____	\$ _____		
Compensation Ins. at \$ _____	per C _____	\$ _____		
Trucking	_____	\$ _____		
Pav't Patch	_____	\$ _____		
O'head	_____	\$ _____		

Blow off for South
Roosevelt St. End
Pl. Ave. No. _____

Name of Owner
168" from gatebox on Coolidge
Ave.
Measured July 28 1965

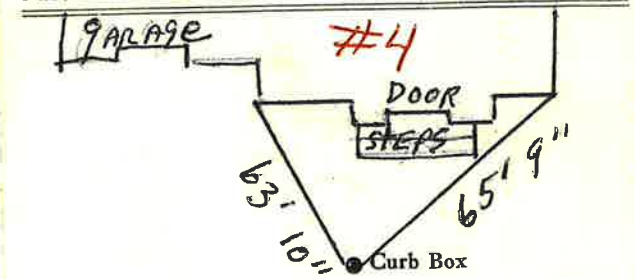

4" Main Elev. of Main at tap 5
Gate at • Gate at •

• Curb Box
Measured from
#4 Roosevelt Ave