

LABOR AND MATERIALS

1	Copper Lead	Connection	6" Tap	\$	
1	Curb	Clock Valve T. S. & V.	6" in.	\$	70.00
1	Service box Old returned	Short 3" X 4" Long 4" X 5" Buff or Rdway		\$	8.50
22'10"	Ft. 6"	Copper Galv. Iron Cast Iron	Pipe at	1.40	32.20
	Nipples	in. at		\$	
	Bushings	to in. at		\$	
	Red'g Inc'g	Couplings	to in. at	\$	
	Union	in. at		\$	
	Meter	in. at		\$	
	Lead Joints at			\$	1.40
4	Compound Joints at	+ 1/2" to 3/4"		\$	34
19	Hrs. Foreman at	W.M.M. - 1	1.01	\$	19.19
33	Hrs. Chauffeur at	W.M.M. - 2	.91	\$	30.03
	Hrs. Tapper at			\$	
59	Hrs. Labor at	80		\$	47.20
	Hrs. Labor at			\$	
2	Hrs. Compressor at	3.00		\$	6.00
	Compensation Ins.			\$	2.13
	Trucking			\$	9.00
	Builders Use of Water	12.90	112.44	\$	13.49
	Tap by Warrington			\$	
	1 3/4" lead		98.55	\$	13.30
	Pat in 8 feet	30 X 3 BT		\$	25.00
				\$	
				\$	277.78

Billed 4.9.55

Asle? 42.70
not chg in

St. Pt. Ave. No. 2

Sagamore

Name of Owner
Trimbley Machine Works

Labor and Mat'l. Report April 1 19 48

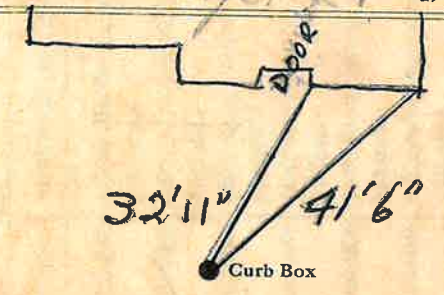

6 Main Elev. of Main at tap 5
Gate at #2-#6 TAX ID # 303.13-8-1 Gate at

● Curb Box

6" Tap CAST IRON