

LABOR AND MATERIALS

1 ~~Copper~~ } Connection 6" X 6" Tee  
 Lead }  
 1 Curb } Cook Valve } 6 in. Gate  
 T.S. & V. }  
 1 Service box { Short 3 1/2 x 4 1/2 }  
 Old returned { Long 4 1/2 x 5 1/2 } \$  
 27'-7" Ft. 6 in. { ~~Copper~~ } Pipe at \$  
 C.I. }  
 Nipples in. at \$  
 Bushings to in. at \$  
 2 Red'g } 6" X 4" INCREASES  
 Ine'g } Coupl'gs to in. at \$  
 Union in. at \$  
 2 Meter Styl in. at 153 Dresser \$  
 Lead Joints at Couplings \$  
 Compound Joints at \$  
 Maintenance Foreman \$  
 Hrs. Water Maint. Man-1 at \$  
 Hrs. Water Maint. Man-2 at \$  
 Hrs. Garage Foreman at \$  
 Hrs. Labor at \$  
 Hrs. Compressor at \$  
 Compensation Ins. at \$ per C \$  
 Trucking \$  
 Pav't Patch \$  
 Tap By Beecher & Co \$  
 O'head August 1976 \$

St. Sagamore  
 Ave. No. 10-12  
 Name of Owner J+J Lingerie  
 Labor and Mat'l. Report Aug 19 76

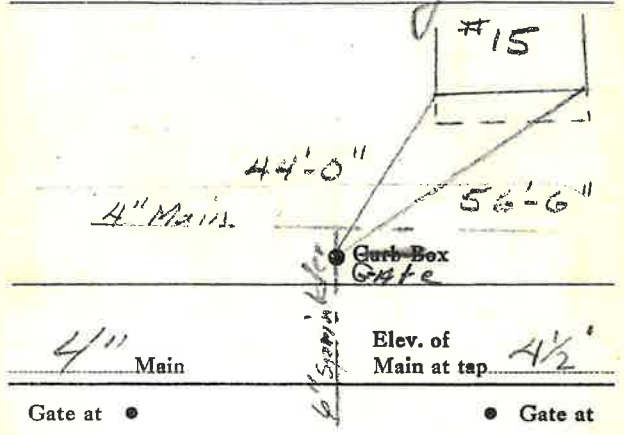

4" Main  
 44'-0"  
 56'-6"  
 4" Main  
 Elev. of Main at top 4 1/2'  
 Gate at • Gate at •  
 #10-#12 TAX ID# 303.13-8-7.1  
 • Curb Box  
 27' 7" to MAIN  
 6" C.I.

LABOR AND MATERIALS

1	Copper	Connection	3/4	\$
	Lead			
1	Curb	Cock Valve	3/4 in.	\$
		T.S. & V.		
1	Service box	Short 3 1/2 x 4 1/2	27"	\$
	Old returned	Long 4 1/2 x 5 1/2		
		Buff or Rdway		
	Ft. 3/4 in.	Copper		\$
		G.I.		
		G.I.		
	Nipples	in. at		\$
	Bushings	to in. at		\$
	Red'g			
	Inc'g	Coupl'gs to in. at		\$
	Union	in. at		\$
	Meter	in. at		\$
	Lead Joints at			\$
	Compound Joints at			\$
	Maintenance Foreman			\$
	Hrs. Water Maint. Man-1 at			\$
	Hrs. Water Maint. Man-2 at			\$
	Hrs. Garage Foreman at			\$
	Hrs. Labor at			\$
	Hrs. Compressor at			\$
	Compensation Ins. at \$	per C		\$
	Trucking			\$
	Pav't Patch			\$
	Tap by Gifford			\$
	Tap by Peter S. O'Neil			\$
	9-63			\$
	O'head			\$
				\$

N. B. C. Bakery

St. 10-18  
Pl. 10-12  
Ave. No.

Sagamore

Name of Owner City of Glens Falls

Play Grounds

Now N. B. C. Bakery

Labor and Mat'l. Report Sept. 19 63

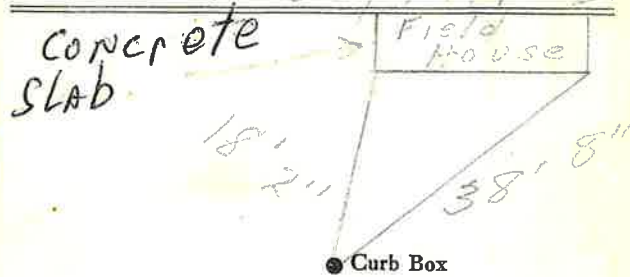

4' Main

Elev. of Main at tap 4'

Gate at

Gate at

3/4" Copper

This Tap in front of lot  
Now owned by N. B. C. Bakery, Purchased from the City 1966.