

Labor and Materials

1	Copper	Connection	3/4		\$ 2.60
	Lead				
1	Curb	Cock Valve T-S & V.	3/4	in.	\$ 2.27
1	Service Box	Short 3/4x4 1/2			\$ 1.38
	Old returned	Long 4x6 1/2			
		Buff or Rdway			
1.2	Ft.	Copper Galv. Iron Pipe at	3/4	in.	\$ 2.16
		Cast Iron			
	Nipples			in. at	\$
1	Bushings		3/4	to 1/2 in. at	\$ 10
	Red'g Inc'g	Couplings		to in. at	\$
	Union			in. at	\$
	Meter			in. at	\$
	Lbs. Br. Stone	at			\$
	Lbs. Sand	at			\$
	Bags Cement	at			\$
	Paving Brick	Mack Red Asphalt		at	\$
	Lead Joints	at			\$
	Leadite Joints	at			\$
14	Hrs. Foreman	at			\$ 8.75
	Hrs. Common Labor	at			\$
	Hrs. Common Labor	at			\$
	Hrs. Mason	at			\$
	Hrs. Mason's Helper	at			\$
1	Hrs. Compressor	at			\$ 1.88
	Compensation Ins				\$ 2.7
	Trucking				\$ 1.00
	Builders' Use of Water	Patch			\$ 5.00
Total \$					24.41

32-12 11
Labor and Material Report

19

no 4 Sagmore st

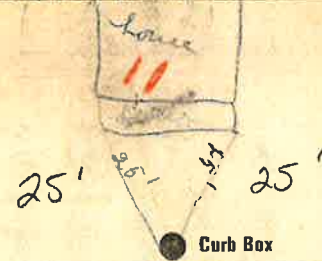

4' Main

Elev of Main at tap 5'

Gate at ●

● Gate at

● Curb Box

TAX ID# 303.13-9-21

12' to main

3/4" COPPER