

Labor and Materials

1	Lead Connection	1	\$
1	Curb Cock	2	\$
	Service Box	{ Short 3" x 4"	\$
	Old returned	{ Long 4" x 5"	\$
		{ Buffalo	\$
2	Ft. in. G. I. Pipe at		\$
	Nipples in. at		\$
	Bushings in. at		\$
	Red'g Coup ... to ... in. at		\$
	Inc'g Coup ... to ... in. at		\$
	Union in. at		\$
	Meter in. at		\$
	Cu. Yds. Br. Stone at		\$
	Cu. Yds. Sand at		\$
	Bags Cement at		\$
	Pav. Brick	{ Mack	} at \$
		{ Red	
		{ Asphalt	
1	Hrs. Foreman at		\$
7	Hrs. Com. Labor at		\$
	Hrs. Mason at		\$
	Hrs. at		\$
	Hrs. at		\$
9	Builders' Use of Water		\$
		at	\$
	Track 10' old connection		\$
	12' Be dug up		\$
		at	\$
		at	\$
	Total	\$	117.6

Labor and Material Report 26 Oct 1921

77 Sanford St to Tap

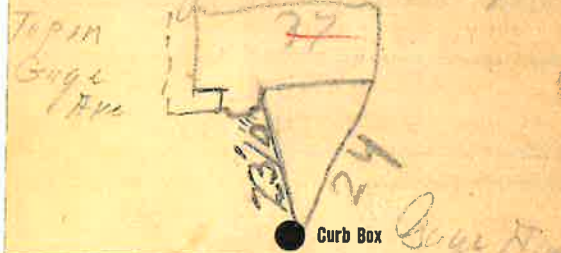

4 Main Elev. of Main at tap 4 1/2

Gate at ● TAX ID # 302.16-12-21 ● Gate at

● Curb Box
To Be dug up on Sanford St
The old connection

22' to main