

LABOR AND MATERIALS

1 Copper } Connection ^{3/4"} \$ _____
 Lead }
 1 Curb } Cock } 3/4" in. \$ _____
 Valve }
 T. S. & V. }
 1 Service box } Short 3 1/2 x 4 1/2 }
 Old returned } Long 4 1/2 x 5 1/2 } \$ _____
 Buff or Rdway }
 10 Ft. 3/4 in. } Copper } Pipe at \$ _____
 } G. I. }
 } C. I. }
 Nipples _____ in. at \$ _____
 Bushings _____ to _____ in. at \$ _____
 Red'g }
 Inc'g } Coupl'gs _____ to _____ in. at \$ _____
 Union _____ in. at \$ _____
 Meter _____ in. at \$ _____
 Lead Joints at \$ _____
 Compound Joints at \$ _____
 Maintenance Foreman \$ _____
 Hrs. Water Maint. Man-1 at \$ _____
 Hrs. Water Maint. Man-2 at \$ _____
 Hrs. Garage Foreman _____ at \$ _____
 Hrs. Labor _____ at \$ _____
 Hrs. Compressor at \$ _____
 Compensation Ins. at \$ _____ per C \$ _____
 Trucking \$ _____
 Pav't Patch \$ _____
 Tap by Gifford & \$ _____
 Cal 96-27-57 \$ _____
 O'head \$ _____
 \$ _____

St.
 -Pl.
 Ave. No. 84

Sanford

Name of Owner

Hack

Labor and Mat'l. Report

June 27 1957

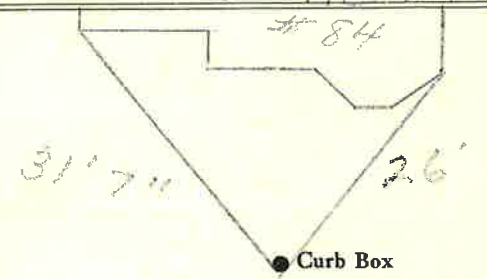

6" Main

Elev. of Main at tap 6'

Gate at • Gate at

TAX ID # 302.16.8-7

• Curb Box

10' to MAIN
3/4" COPPER