

LABOR AND MATERIALS

1	Copper Lead	Connection	3/4		\$ 1.23
1	Curb	Cock Valve T. S. & V.	3/4 in.		\$ 1.68
1	Service Box Old returned	Short 3 1/2 x 4 1/2 Long 4 1/2 x 5 1/2 Buff. or Rdway			\$ 1.54
23 Ft.	3/4 in.	Copper Galv-Iron Cast Iron	Pipe at 17		\$ 3.91
	Nipples	in. at			\$
	Bushings	to in. at			\$
	Red'g Inc'g	Couplings	to in. at		\$
	Union	in. at			\$
	Meter	in. at			\$
	Lead Joints	at			\$
	Leadite Joints	at			\$
	Hrs. Foreman	at			\$
2	Hrs. Chauffeur	at	6 1/2		\$ 1.25
8	Hrs. Tapper	at			\$ 5.00
8	Hrs. Labor	at	45		\$ 3.60
	Hrs. Labor	at			\$
	Hrs. Compressor	at			\$
	Compensation Ins.				\$ 30
	Trucking				\$ 1.-
	Builders Use of Water	Patch			\$ 5.-
	Tep by Messel				\$
					\$
					\$
					\$
					\$
					\$ 24.51

04--1939

St.

Pl-

Sanford

Ave. No. 103

Name of Owner

Hodgson

Labor and Mat'l. Report

Nov 11

1939

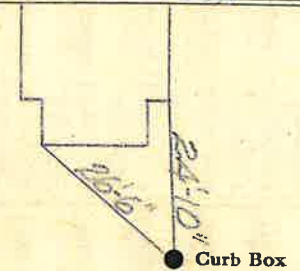

● Curb Box

6 Main

Elev. of

Main at tap 6

Gate at ●

● Gate at

TAX ID # 302.16-13.9

● Curb Box

23' to main
3/4" copper

old shut off