

LABOR AND MATERIALS

1	Copper Connection	$\frac{3}{4}$ "		\$ 2.76
1	Lead			
1	Curb	$\frac{3}{4}$ in.		\$ 3.49
	Cock Valve T. S. & V.			
1	Service box	Short $3\frac{1}{2} \times 4\frac{1}{2}$		
	Old returned	Long $4\frac{1}{2} \times 5\frac{1}{2}$		\$ 4.74
		Buff or Rdway		
28	Ft. $\frac{3}{4}$ in.	Copper Pipe at 38		\$ 10.64
		G. I.		
		C. I.		
	Nipples	in. at		\$
	Bushings	to in. at		\$
	Red'g			
	Inc'g	Coupl'gs to in. at		\$
	Union	in. at		\$
	Meter	in. at		\$
	Lead Joints	at		\$
	Compound Joints	at		\$
	Hrs. Water Maint. Man-1	at		\$
6	Hrs. Water Maint. Man-2	at 1.24		\$ 7.44
2	Hrs. Labor	at 1.13		\$ 23.73
	Hrs. Labor	at		\$
2	Hrs. Compressor	at 1.50		\$ 3.00
	Compensation Ins. at \$	4.406 per C		\$ 1.37
	Trucking			\$ 1.00
	Pay't Patch			\$ 25.76
	Tap made	Nov 6-53		\$
	by	Gifford		\$
	O'head			\$
				\$ 93.93

100-53

St.
Pl. Sanford
Ave. No. 78

Name of Owner

TAX ID # 302.16-429

Labor and Mat'l. Report

Nov 6 1953

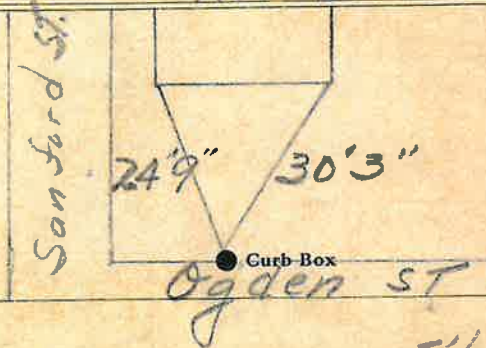

4" Main Elev. of Main at tap 5'1/2"

Gate at ● 28' to main ● Gate at

3/4 copper

Sanford St.

measured
in after
fire

Feb. 16-63

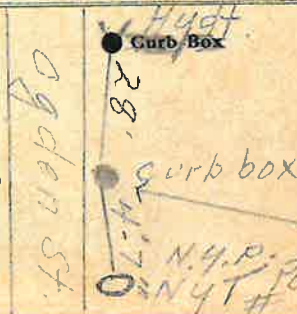

L9M-5C 5 15-48