

**Labor and Materials**

1	Copper } Connection <i>3/4</i>	\$ 2.60
	Lead	
1	Curb } Cock Valve	\$ 2.27
	T.S. & V. } <i>3/4</i> in.	
1	Service Box } Short <i>3 1/2</i> x <i>4 1/2</i>	\$ 1.58
	Old returned } Long <i>4 1/2</i> x <i>5 1/2</i>	
		Buff. or Rdway
10	Pt. } <i>3/4</i> in. } Copper	\$ 1.80
		Galv. Iron
		Cast Iron
	Nipples..... in. at.....	\$
	Bushings..... to..... in. at.....	\$
	Red'g } Couplings..... to..... in. at.....	\$
	Inc'g }	
	Union..... in. at.....	\$
	Meter..... in. at.....	\$
	Lbs. Br. Stone at.....	\$
	Lbs. Sand at.....	\$
	Bags Cement at.....	\$
	Paving Brick } Mack	\$
		Red
		Asphalt
	Lead Joints at.....	\$
	Leadite Joints at.....	\$
2	Hrs. Foreman at.....	\$ 1.25
7	Hrs. Common Labor at <i>Tapper</i>	\$ 3.50
8	Hrs. Common Labor at.....	\$ 3.60
	Hrs. Mason at.....	\$
	Hrs. Mason's Helper at.....	\$
	Hrs. Compressor at.....	\$
	Compensation Ins.....	\$ .26
	Trucking.....	\$ 1.—
	Builders' Use of Water <i>Patch</i>	\$ 5.—
Total		\$ 22.66

*3/4" tap at 27 Sanford*

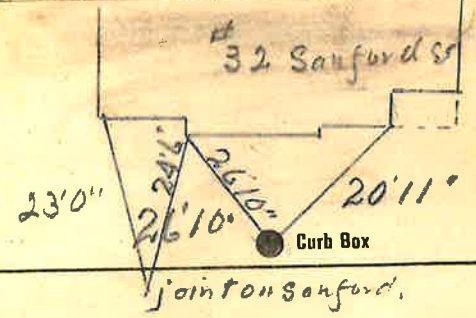

4 Main Tap on *Oregon St* Elev of Main at tap *7 1/2*

Gate at ● TAX ID # 302.16-5-29 ● Gate at

● Curb Box

*Old tap to be dug up*

*10' to MAIN  
 3/4" COPPER*

*OK 9/10*