

LABOR AND MATERIALS

1 Copper } Connection $\frac{3}{4}$ " \$ _____
 1 Lead }
 1 Curb } Cook } $\frac{3}{4}$ in. \$ _____
 } Valve }
 } T.S. & V. }
 1 Service box { Short $3\frac{1}{2} \times 4\frac{1}{2}$ } \$ _____
 Old returned { Long $4\frac{1}{2} \times 5\frac{1}{2}$ }
 { Buff or Rdway }
 24 Ft. $\frac{3}{4}$ in. { Copper } Pipe at \$ _____
 { G.I. }
 { C.I. }
 Nipples in. at \$ _____
 Bushings to in. at \$ _____
 1 Red'g } Coupl'gs 1 to $\frac{3}{4}$ in. at \$ _____
 1 Ine'g }
 Union in. at BRASS \$ _____
 Meter in. at \$ _____
 Lead Joints at \$ _____
 Compound Joints at \$ _____
 Maintenance Foreman \$ _____
 Hrs. Water Maint. Man-1 at \$ _____
 Hrs. Water Maint. Man-2 at \$ _____
 Hrs. Garage Foreman at \$ _____
 Hrs. Labor at \$ _____
 Hrs. Compressor at \$ _____
 Compensation Ins. at \$ _____ per C \$ _____
 Trucking \$ _____
 Pav't Patch \$ _____
 Tap by GISSORD \$ _____
 + Co. 11-27-63 \$ _____
 O'head \$ _____

St. Sanford
 Pl. Ave. No. 173

Name of Owner
 Ray Bennett.

Labor and Mat'l. Report Nov. 27, 1963

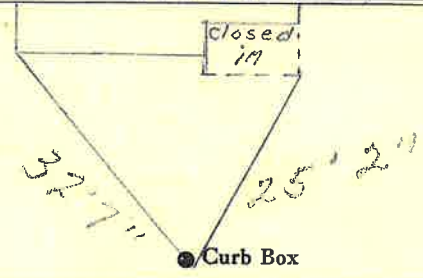

6" Main Elev. of Main at tap 4'
 Gate at • Gate at

TAX ID # 303.9-14-3

• Curb Box
 TAP ON SIDE OF
 MAIN
 24' TO MAIN
 3/4" COPPER