

LABOR AND MATERIALS

1	Copper Lead	Connection	3/4	\$ 1.43
1	Curb	Cock Valve T.S. & V.	3/4 in.	\$ 1.88
1	Service Box Old returned	Short 3 1/2 x 4 1/2 Long 4 1/2 x 5 1/2 Buff. or Rdway		\$ 1.75
25	Ft.	3/4 in. Copper Galv Iron Cast Iron	Pipe at 15	\$ 3.75
	Nipples	in. at		\$
	Bushings	to in. at		\$
	Red'g Inc'g	Couplings to in. at		\$
	Union	in. at		\$
	Meter	in. at		\$
	Lead Joints	at		\$
	Leadite Joints	at		\$
	Hrs. Foreman	at		\$
3	Hrs. Chauffeur	at	6 2 1/2	\$ 1.88
3	Hrs. Tapper	at	6 2 1/2	\$ 1.88
4	Hrs. Labor	at	45	\$ 1.80
	Hrs. Labor	at		\$
	Hrs. Compressor	at		\$
	Compensation Ins.			\$.17
	Trucking			\$ 1.00
	Builders Use of Water			\$
	Taphel Hassell			\$
	1/2 cost of patch (Sewer)			\$ 2.50
				\$
				\$
				\$ 18.04

11-1938

St.

Sanford

Pl.

Ave. No. 175

Name of Owner

Brinks

Labor and Mat'l. Report

Apr 12

1938

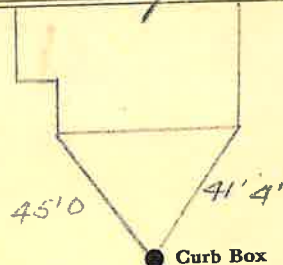

6 Main

Elev. of Main at tap 4 1/2

Gate at ●

● Gate at

TAX ID # 303.9-14-2

● Curb Box

25' New Tap to MAIN
3/4" copper