

**Labor and Materials**

1	Copper	Connection	3/4"	\$ 2.60
	Lead			
1	Curb	Cock Valve	3/4" in.	\$ 2.27
		T. S. & V.		
1	Service Box	Short 3/4"x4 1/2"		\$ .38
	Old returned	Long 4 1/2"x5 1/2"		
		Buff. or Rdway		
26	Ft.	3/4" in.	Copper Galv. Iron Pipe at	\$ 4.68
			Cast Iron	
	Nipples	in. at		\$
	Bushings	to in. at		\$
	Red'g Inc'g	Couplings to in. at		\$
	Union	in. at		\$
	Meter	in. at		\$
	Lbs. Br. Stone	at		\$
	Lbs. Sand	at		\$
	Bags Cement	at		\$
	Paving Brick	Mack Red Asphalt at		\$
	Lead Joints	at		\$
	Leadite Joints	at		\$
6	Hrs.	Foreman at		\$ 3.75
3	Hrs.	Common Labor at	Tapper	\$ 1.50
4	Hrs.	Common Labor at		\$ 1.80
	Hrs.	Mason at		\$
	Hrs.	Mason's Helper at		\$
	Hrs.	Compressor at		\$
	Compensation	Ins		\$ 72
	Trucking			\$ 1
	Builders' Use of Water	no Patch (E.T.)		\$
				Total \$ 19.20

**Labor and Material Report**

#3 Dec 1 1931

Block 2 Lot 4 Seargent St

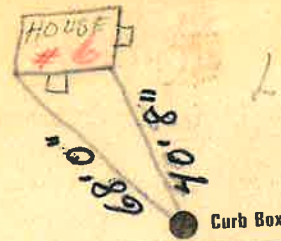

Lot  
TAP

6" Main

Elev of Main at tap 4 1/2

Gate at

Gate at

Curb Box

1 length 6" 68 pipe 12ft  
2 joints leadite  
2 " joints  
gas

measured  
from #6,  
26' TO MAIN  
3/4" COPPER