

Labor and Materials

1	Copper } Connection $\frac{3}{4}$ "	\$1.50
1	Lead } Connection $\frac{3}{4}$ "	\$1.50
1	Curb { Cock Valve T.S.&V. } $\frac{3}{4}$ " in	\$1.70
1	Service Box { Short $3\frac{1}{2} \times 4\frac{1}{2}$ Long $4\frac{1}{2} \times 5\frac{1}{2}$ Old returned Buff. or Rdway }	\$1.54
1.1	Ft. $\frac{3}{4}$ " in. { Copper Galv. Iron Cast Iron } Pipe at	\$2.09
	Nipples in. at	\$
	Bushings to in. at	\$
	Red'g Inc'g } Couplings to in. at	\$
	Union in. at	\$
	Meter in. at	\$
	Lbs. Br. Stone at	\$
	Lbs. Sand at	\$
	Bags Cement at	\$
	Paving Brick { Mack Red Asphalt } at	\$
	Lead Joints at	\$
	Leadite Joints at	\$
2	Hrs. Foreman at $\frac{1}{2}$ hr	\$1.25
6	Hrs. Common Labor at 50	\$3.00
8	Hrs. Common Labor at 45	\$3.60
	Hrs. Mason at	\$
	Hrs. Masons Helper at	\$
	Hrs. Compressor at	\$
	Compensation Ins	\$0.78
	Trucking	\$1.00
	Builders Use of Water	\$
Total		\$15.96

117 34

Labor and Material Report Sept 20 1900

11 Second St

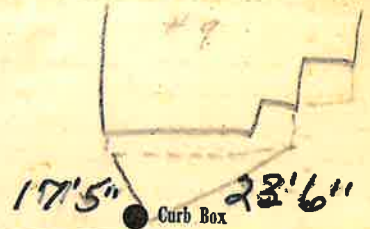

6 Main

Elev. of Main at tap $5\frac{1}{2}$

Gate at TAX ID # 309.12.8-16 Gate at

11' to MAIN Curb Box
 $\frac{3}{4}$ COPPER
 did shut off at main

(Handwritten signature)

Godette