

Labor and Materials

1	Copper	} Connection <sup>3/4</sup>	.....	\$ 1.50
1	Lead			
1	Curb	} Cock Valve T.S.&V. <sup>3/4</sup> in	.....	\$ 1.70
1	Service Box			
	Old returned	} Short <sup>3 1/2</sup> x <sup>4 1/2</sup> Long <sup>4 1/2</sup> x <sup>5 1/2</sup> <del>Ball or return</del>	.....	\$ 1.50
22	Ft. <sup>3/4</sup> in			
		} Copper Galv. Iron Cast Iron	Pipe at	\$ 4.18
	Nipples			in. at
	Bushings	.....to.....in. at		\$
	Red'g Inc'g	} Couplings.....to.....in. at		\$
	Union			in. at
	Meter	.....in. at		\$
	Lbs. Br. Stone	at		\$
	Lbs. Sand	at		\$
	Bags Cement	at		\$
	Paving Brick	} Mack Red Asphalt	at	\$
	Lead Joints			at
	Leadite Joints	at		\$
3	Hrs. Foreman	at	<sup>67 1/2</sup>	\$ 1.88
16	Hrs. Common Labor	at	<sup>45</sup>	\$ 7.20
	Hrs. Common Labor	at		\$
	Hrs. Mason	at		\$
	Hrs. Masons Helper	at		\$
	Hrs. Compressor	at		\$
	Compensation Ins	.....		\$ 2.33
	Trucking	.....		\$ 1.15
	Builders Use of Water	.....		\$
Total \$				19.33

86 34

Labor and Material Report

Sept 1

1931

18 Second St

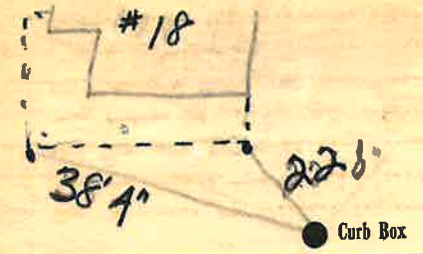

6" Main

Elev. of Main at tap <sup>5 1/2</sup>

Gate at TAX ID # 309.12-10-14 Gate at

22' to MAIN ● Curb Box  
 3/4" COPPER  
 old shut off at  
 main  
 [Signature]

Sam Corcoran