

**Labor and Materials**

1	Copper } Connection.....	3/4	\$ 1.50
1	Lead } .....		
1	Curb { Cock } .....	3/4 in	\$ 1.70
	{ Valve } .....		
	{ T.S.&V. } .....		
1	Service Box { Short 3/4 x 1 1/2 } .....		\$ 1.50
	Old returned { Long 4 1/2 x 5 1/2 } .....		
	{ Buff. or Rdway } .....		
9	Ft. 3/4 in. { Copper } Pipe at .....		\$ 1.71
	{ Galv. Iron } .....		
	{ Cast Iron } .....		
	Nipples .....	in. at	\$
	Bushings .....	to .....	in. at \$
	Red'g } Couplings.....	to .....	in. at \$
	Inc'g } .....		
	Union.....	in. at	\$
	Meter.....	in. at	\$
	Lbs. Br. Stone at .....		\$
	Lbs. Sand at .....		\$
	Bags Cement at .....		\$
	Paving Brick { Mack } at .....		\$
	{ Red } .....		
	{ Asphalt } .....		
	Lead Joints at .....		\$
	Leadite Joints at .....		\$
7	Hrs. Foreman at .....	6 1/2 hr	\$ 1.25
8	Hrs. Common Labor at .....	5 hr	\$ 1.00
	Hrs. Common Labor at .....		\$
	Hrs. Mason at .....		\$
	Hrs. Masons Helper at .....		\$
	Hrs. Compressor at .....		\$
	Compensation Ins .....		\$ 0.19
	Trucking .....		\$ 1.00
	Builders Use of Water .....		\$
Total \$			12.89

*27 Second St.*

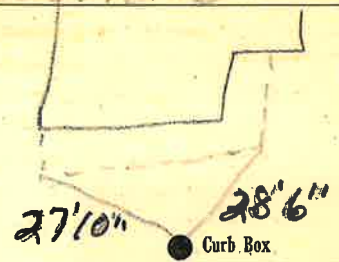

6' Main Elev. of Main at tap *5 1/2*

Gate at TAX ID # 309.12-7-27 Gate at

● Curb Box

*old shut off main*

*9' to MAIN  
3/4" COPPER*

*[Signature]*

*V.M. CASH*

*POTTER*