

Labor and Materials

Copper } Connection.....	3/4	\$ 1.50
Lead }	3/4	
Curb { Cock Valve }	3/4	\$ 1.70
{ T.S.C.V. }	3/4	
Service Box { Short 3 1/2 x 4 1/2 }		\$ 1.44
Old returned { Long 4 1/2 x 5 1/2 }		
{ Buff. or Redwa. }		
9 Ft. 3/4 in. { Copper } Pipe at		\$ 1.71
{ Galv. Iron }		
{ Cast Iron }		
Nipples	in. at	\$
Bushings	to	in. at \$
Red'g } Couplings.....	to	in. at \$
Inc'g }		
Union.....	in. at	\$
Meter.....	in. at	\$
Lbs. Br. Stone	at	\$
Lbs. Sand	at	\$
Bags Cement	at	\$
Paving Brick { Mack }		\$
{ Red }		
{ Asphalt }		
Lead Joints	at	\$
Leadite Joints	at	\$
3 Hrs. Foreman	at 62 1/2	\$ 1.88
17 Hrs. Common Labor	at 45	\$ 5.40
Hrs. Common Labor	at	\$
Hrs. Mason	at	\$
Hrs. Masons Helper	at	\$
Hrs. Compressor	at	\$
Compensation Ins		\$ 9.26
Trucking		\$ 1.-
Builders Use of Water		\$

Total \$ 14.89

55 Second St

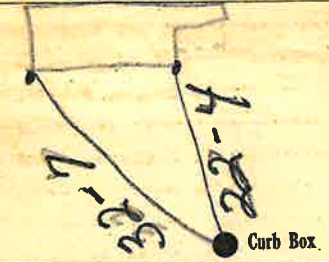

6 Main Elev. of Main at tap 5

Gate at TAX ID # 309.11-7-21 Gate at

● Curb Box
old Tap shut off at
Main
9' to MAIN
3/4" COPPER
M

1/2