

## LABOR AND MATERIALS

<u>3/4</u>	Copper Lead	Connection	\$	
	Curb } Cock } Valve } T.S. & V. }	_____ in.	\$	
		Service box { Short 3-1/2 x 4-1/2 } Old returned { Long 4-1/2 x 5-1/2 }	\$	
<u>11</u>	Ft. _____ in.	Copper G.I. C.I. } Pipe at	\$	
	Nipples _____ in.	at _____	\$	
	Bushings _____ to _____ in.	at _____	\$	
	Red'g _____		\$	
	Inc'g _____		\$	
	Union _____ in.	at _____	\$	
	Meter _____ in.	at _____	\$	
			\$	
	Compound Joints	at _____	\$	
	Maintenance Foreman _____		\$	
	Hrs. Water Maint. Man - 1	at _____	\$	
	Hrs. Water Maint. Man - 2	at _____	\$	
	Hrs. Garage Foreman _____	at _____	\$	
	Hrs. Labor _____	at _____	\$	
	Hrs. Compressor at _____		\$	
			\$	
	Trucking _____		\$	
	Pav't Patch _____		\$	
			\$	
			\$	
			\$	
			\$	

St. \_\_\_\_\_  
Pl. Ave. No. 18

Name of Owner \_\_\_\_\_  
TAX ID # 302.19-11-10

Labor and Mat'l. Report 19 \_\_\_\_\_

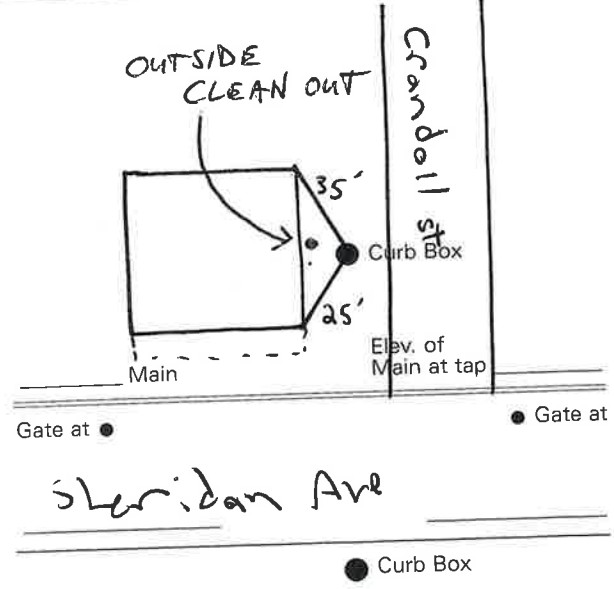

Sewer 20' of 4" SDR35