

LABOR AND MATERIALS

1	Copper	Connection	3/4"	\$ 2.76
	Lead			
1	Curb	Cock Valve T. S. & V.	3/4 in.	\$ 3.49
1	Service box	Short 3 1/2 X 4 1/2		4.74
	Old returned	Long 4 1/2 X 5 1/2		
		Buff or Rdway		
23	Ft.	Copper	3/4 in. Pipe at 38	\$ 8.74
		G.I.		
		G.I.		
	Nipples	in. at		\$
	Bushings	to in. at		\$
	Red'g			
	Inc'g	Coupl'gs to in. at		\$
	Union	in. at		\$
	Meter	in. at		\$
	Lead Joints	at		\$
	Compound Joints	at		\$
	Hrs. Water Maint. Man-1	at		\$
3	Hrs. Water Maint. Man-2	at 1.24		\$ 3.72
	Hrs. Labor-	at		\$
	Hrs. Labor-	at		\$
	Hrs. Compressor	at		\$
	Compensation Ins.	at \$40.6. per C.		\$ 16.
	Trucking			\$ 1.00
	Pav't Patch			\$ 13.50
	Tap by Jiffard	7-24-53		\$
	O'head			\$
				\$ 38.11

2461

St. Sheridan Pt. Ave. No. 73

Name of Owner Hill

Labor and Mat'l. Report July 24 1953

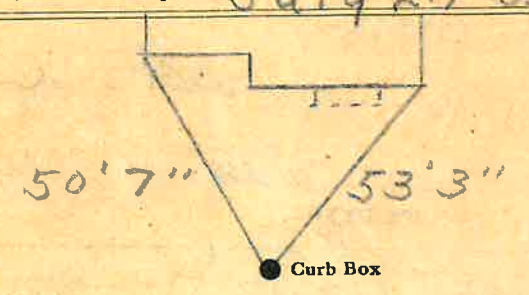

6" Main Elev. of Main at tap 4'

Gate at 23' to MAIN 3/4" copper

This Lot r House Curb Box May Have 2 Taps.

TAX ID# 302.19-3-15