

Labor and Materials

1	Copper } Connection.....	\$ 3.20
	Lead }	
1	Curb { Cock }	\$ 1.70
	Valve }	
	T. S. & V. }	
1	Service Box { Short 3 1/2 x 4 1/2 }	\$ 1.30
	Old returned { Long 4 1/2 x 5 1/2 }	
		Buff. or Rdway }
1.0	Ft. in. { Copper } Pipe at.....	\$ 2.20
		Galv. Iron }
		Cast Iron }
	Nipples..... in. at.....	\$
	Bushings..... to..... in. at.....	\$
	Red'g } Couplings..... to..... in. at.....	\$
	Inc'g }	
	Union..... in. at.....	\$
	Meter..... in. at.....	\$
	Lbs. Br. Stone at.....	\$
	Lbs. Sand at.....	\$
	Bags Cement at.....	\$
	Paving Brick { Mack } at.....	\$
		Red }
		Asphalt }
	Lead Joints at.....	\$
	Leadite Joints at.....	\$
1	Hrs. Foreman at.....	\$ 63
	Hrs. Common Labor at.....	\$
3	Hrs. Common Labor at.....	\$ 123
	Hrs. Mason at.....	\$
	Hrs. Mason's Helper at.....	\$
	Hrs. Compressor at.....	\$
	Compensation Ins.....	\$ 05
	Trucking.....	\$ 1.00
	Builders' Use of Water.....	\$
Total		\$ 11.61

Labor and Material Report

July 13 1927

37 Sheridan St

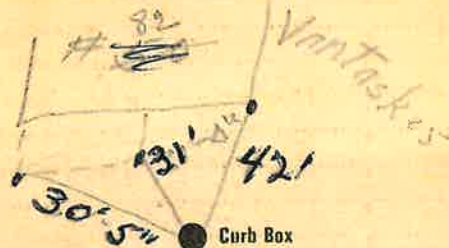

6" Main

Elev. of Main at tap 5'

Gate at

TAX ID # 302.19-7-2

Gate at

Curb Box

10' to main
copper

1000