

COPY
Labor and Materials

1	Copper Lead	Connection	1/2"		\$
2	Curb	Cock Valve T. S. & V.	3/4"	in	\$
2	Service Box Old returned	Short 3 1/2 x 4 1/2 Long 4 1/2 x 5 1/2 Buff. or Rdway			\$
23	Ft.	3/4" in.	Copper Galv Iron Cast Iron	Pipe at	\$
3	Nipples	3/4" in.		at	\$
2	Bushings	3/4" x 1/2"		to in. at	\$
	Red'g Inc'g	Couplings		to in. at	\$
1	Union	1/2" in.		at	\$
	Meter			in. at	\$
	Lead Joints			at	\$
	Leadite Joints			at	\$
2	Hrs. Foreman			at	\$
	Hrs. Chauffeur			at	\$
	Hrs. Tapper			at	\$
12	Hrs. Labor			at	\$
	Hrs. Labor			at	\$
	Hrs. Compressor			at	\$
	Compensation Ins.				\$
	Trucking				\$
70	Builders Use of Water				\$
	1 - 3/4" Tee				\$
	1 - 3/4" Ell				\$
	1 - 1/2" Nipple				\$
	TRUCK 100				\$

\$ 15.40

St. Pt. Ave. No. 23

Sherman

Name of Owner

Labor and Mat'l. Report Aug. 15 1923

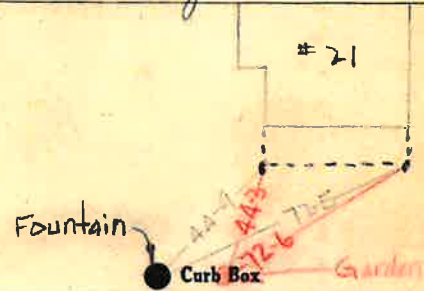

6 Main

Elev. of Main at tap 4

Gate at •

• Gate at

23' to main

• Curb Box