

LABOR AND MATERIALS

1	Copper	Connection	3/4"	\$
1	Lead	Cock	3/4" in.	\$
1	Curb	Valve	3/4" in.	\$
		T.S. & V.		
1	Service box	Short 3 1/2 x 4 1/2		\$
	Old returned	Long 4 1/2 x 5 1/2		\$
		Buff or Rdway		\$
29	Ft.	Copper	3/4" in.	\$
		G. I.		\$
		C. I.		\$
	Nipples	in. at		\$
	Bushings	to in. at		\$
	Red'g	Coupl'gs	to in. at	\$
	Inc'g			\$
	Union	in. at		\$
	Meter	in. at		\$
	Lead Joints	at		\$
	Compound Joints	at		\$
	Maintenance Foreman			\$
	Hrs. Water Maint. Man	1 at		\$
	Hrs. Water Maint. Man	2 at		\$
2 1/4	Hrs. Garage Foreman	at		\$
2 1/4	Hrs. Labor	at		\$
	Hrs. Compressor	at		\$
	Compensation Ins.	at \$ per C		\$
	Trucking			\$
	Pav't Patch			\$
	No. Builder Use of Vat	\$		\$
	O'head			\$

Sherman St. Pl. Ave. No. 71

Name of Owner  
TAX ID# 302.19-28-22

Located & measured in 1961  
Labor and Mat'l. Report 19

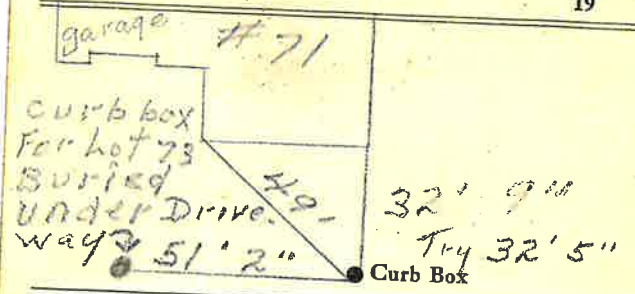

6" Main Elev. of Main at tap 5'

Gate at ● Gate at ●  
29' to MAIN  
3/4" Copper

● Curb Box  
one house on two lots #71 + 73.  
Two Taps, using #71.