

Labor and Materials

Lead Connection ^{3/4}	\$
Curb Cock ^{3/4}	\$
Service Box (Short 3' x 4')	\$
Old returned (Long 4' x 5')	\$
9 Ft. ^{3/4} in. C.P. Pipe at ^{CP}	\$
Nipples..... in. at.....	\$
X Bushings..... to..... in. at.....	\$
Red'g Coup..... to..... in. at.....	\$
Inc'g Coup..... to..... in. at.....	\$
Union..... in. at.....	\$
Meter..... in. at.....	\$
Cu. Yds. Br. Stone at.....	\$
Cu. Yds. Sand at.....	\$
Bags Cement at.....	\$
Paving Brick { Mack Red Asphalt } at.....	\$
1 1/2 Hrs. Foreman at.....	\$
9 1/4 Hrs. Common Labor at.....	\$
Hrs. Mason at.....	\$
Hrs..... at.....	\$
Hrs..... at.....	\$
Builders' Use of Water.....	\$
..... at.....	\$
..... at.....	\$
..... at.....	\$
..... at.....	\$
..... at.....	\$
Total	\$ 12.08	

Labor and Material Report

19

80 Sherman Ave.

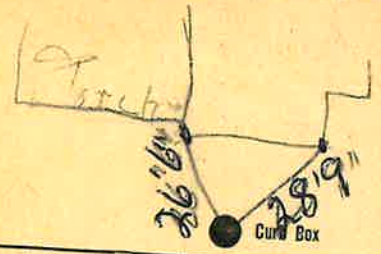

TAX ID # 309.7.8-13

Main Elev. of Main at tap
 Gate at ● 9' to main
 3/4" COPPER ● Gate at

