

LABOR AND MATERIALS

Copper Lead	} Connection	\$
Curb	{ Clock Valve T. S. & V. } in.	\$
Service box	{ Short 3 1/2 X 4 1/2 Long 4 1/2 X 5 1/2 Buff or Rdway }	\$
Old returned			
10 Ft. 3/4 in.	{ Copper Galv. Iron Cast Iron }	Pipe at	\$
Nipples in. at		\$
Bushings to in. at		\$
Red'g Inc'g	} Couplings to in. at	\$
Union in. at		\$
Meter in. at		\$
Lead Joints at			\$
Compound Joints at			\$
Hrs. Foreman at			\$
Hrs. Chauffeur at			\$
Hrs. Tapper at			\$
Hrs. Labor at			\$
Hrs. Labor at			\$
Hrs. Compressor at			\$
Compensation Ins.			\$
Trucking			\$
Builders Use of Water.			\$
Walsingham Geo			\$
			\$
			\$
			\$
			\$
			\$

St. _____
Pl. _____
Ave. No. 82

Name of Owner _____

Labor and Mat'l. Report July 1945

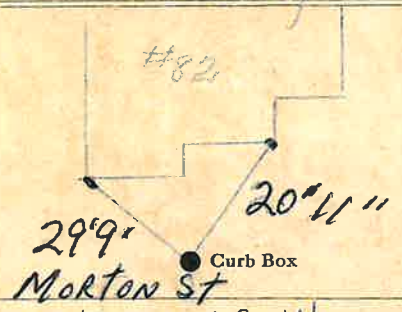

TAX ID # 309.7-8-14

..... Main Elev. of Main at tap.....

Gate at ● ● Gate at

10' to main
3/4" copper

..... Curb Box

NEW TAP 1993

This TAP ON MORTON ST.