

LABOR AND MATERIALS

Copper	{ Connection	\$
Lead	{	\$
1	Curb { Cock	3/4	in.	\$ 3.54
	{ Valve			
	{ T.S. & V.			
1	Service box	Short 3 1/2 x 4 1/2		
	Old returned	Long 4 1/2 x 5 1/2		\$ 4.70
		Buff or Rdway		
6 1/2	3/4 in.	Copper	Pipe at 35	\$ 2.28
		G.I.		
		G.I.		
Nipples	in. at	\$
Bushings	to in. at	\$
Red'g	{ Coupl'gs	to in. at	\$
Inc'g	{			
Union	in. at	\$
Meter	in. at	\$
Lead Joints	at	\$
Compound Joints	at	\$
Hrs. Water Maint. Man	- 1 at	\$
Hrs. Water Maint. Man	- 2 at	\$
Hrs. Labor	at	\$
Hrs. Labor	at	\$
Hrs. Compressor	at	\$
Compensation Ins.	at \$ per C.	\$
Trucking		\$	1.00
Pav't Patch		\$
1	1 1/2" x 1 1/2" x 3/4" G.I. Tee		\$	53
1	3/4" Copper Tee Adapter		\$
1	" " Tee to Cu Adapter		\$
O'head		\$

Tap made by Miller
Oct 31-1951

Sherman Town Rd ✓
St.

Roger's Terrace Pl.
Ave. No.

Name of Owner

Joseph Vannier

Labor and Mat'l. Report

Oct 31 1951

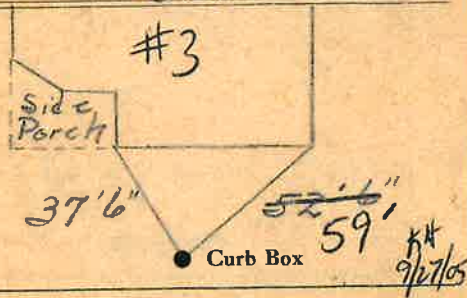

1 1/2' Main

Elev. of Main at tap 4 1/2'

Gate at ●

● Gate at

● Curb Box

6 1/2' to main

3/4" copper