

Labor and Materials

1	Copper } Connection	3/4"	\$ 2.70
1	Lead } Cock Valve	3/4" in.	\$ 2.39
1	Curb } T.S. & V.		
1	Service Box } Short 3 1/2 x 4 1/2		\$ 1.45
1	Old returned } Long 4 1/2 x 5 1/2		
16	Added on } Buff. or Rdway		
4	1/2 Ft. } Copper Galv. Iron Pipe at		\$ 12.69
1	Cast Iron		
1	Nipples	in. at	\$
	Bushings	to in. at	\$
	Red'g } Couplings	to in. at	\$
	Inc'g }		
	Union	in. at	\$
	Meter	in. at	\$
	Lbs. Br. Stone at		\$
	Lbs. Sand at		\$
	Bags Cement at		\$
	Paving Brick } Mack Red Asphalt	at	\$
	Lead Joints at		\$
	Leadite Joints at		\$
	Hrs. Foreman at		\$ 5.-
	Hrs. Common Labor at	Tapper 2.50	\$ 1.50
	Hrs. Common Labor at	.45	\$ 3.60
	Hrs. Mason at		\$
	Hrs. Mason's Helper at		\$
	Hrs. Compressor at		\$
	Compensation Ins		\$.31
	Trucking		\$ 1.-
	Builders' Use of Water	Patch	\$ 25.-
	Total		\$ 55.64

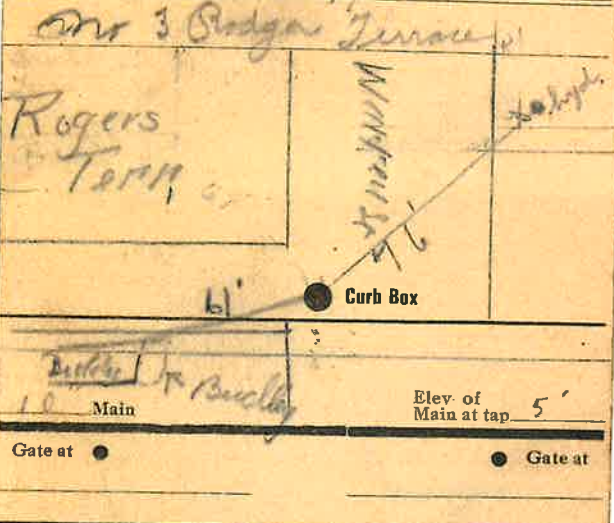

10 Main
 Gate at ●
 ● Curb Box
 ● Gate at
 174
 33.94
 Old Lot sheet off