

LABOR AND MATERIALS

1	Copper	Connection	3/4"	\$
1	Lead	Cock		\$
1	Curb	Valve	3/4 in.	\$
		T. S. & V.		\$
1	Service box	Short 3 1/2 x 4 1/2		\$
	Old returned	Long 4 1/2 x 5 1/2		\$
		Buff or Rdway		\$
9	3/4 in.	Copper	Pipe at	\$
		G. I.		\$
		C. I.		\$
	Nipples	in. at		\$
	Bushings	to in. at		\$
	Red'g			\$
	Inc'g	Coupl'gs. to in. at		\$
	Union	in. at		\$
	Meter	in. at		\$
	Lead Joints at			\$
	Compound Joints at			\$
	Maintenance Foreman			\$
	Hrs. Water Maint. Man-1 at			\$
	Hrs. Water Maint. Man-2 at			\$
	Hrs. Garage Foreman at			\$
	Hrs. Labor at			\$
	Hrs. Compressor at			\$
	Compensation Ins. at \$	per C		\$
	Trucking			\$
	Pav't Patch			\$
	Tap by Foley T.			\$
	Giggard 9-23-58			\$
	O'head			\$

St. 29
 -Pl-
 Ave. No. 31

Shipped
 Name of Owner Irving Smith

Labor and Mat'l. Report Sept. 23 1958

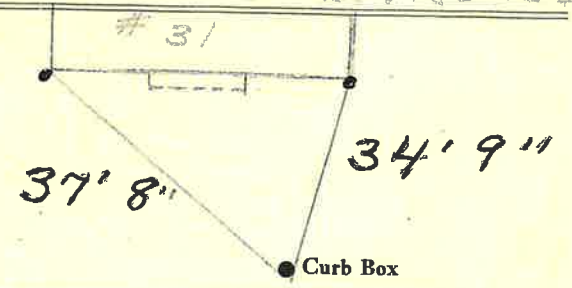

6" Main Elev. of Main at tap 6'

Gate at • Gate at

9' to MAIN

3/4" copper • Curb Box

TAX ID# 302.19.21-9