

Labor and Materials

.....	Copper } Connection	3	\$ 2.70
.....	Curb } Cock Valve	2	\$ 2.39
.....	Old returned } Short 3/4x1/2		
.....	} Long 4x6		
.....	} Buff or Rdway		\$ 1.45
9	Ft. in. } Copper Galv. Iron Pipe at	3/4	\$ 2.43
.....	Nipples .. in. at		\$
.....	Bushings .. to .. in. at		\$
.....	Red'g } Couplings .. to .. in. at		\$
.....	Inc'g }		\$
.....	Union .. in. at		\$
.....	Meter .. in. at		\$
.....	Lbs. Br. Stone at		\$
.....	Lbs. Sand at		\$
.....	Bags Cement 'at		\$
.....	Paving Brick } Mack } at		\$
.....	} Red }		\$
.....	} Asphalt }		\$
.....	Lead Joints at		\$
.....	Leadite Joints at		\$
4	Hrs. Foreman at		\$ 2.50
32	Hrs. Common Labor at		\$ 14.40
.....	Hrs. Common Labor at		\$
.....	Hrs. Mason at		\$
.....	Hrs. Mason's Helper at		\$
.....	Hrs. Compressor at		\$
.....	Compensation Ins.		\$.52
.....	Trucking		\$ 1 -
.....	Builders' Use of Water		\$
			Total \$ 27.39

30-162 212 SOUTH
 Labor and Material Report Nov. 11 1930

212 South St (E.D.)

Old #154

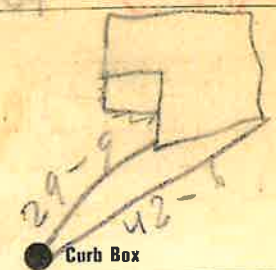

6 Main Elev of Main at tap 4 1/2
 Gate at 9" to MAIN Gate at
 3/4" copper
 Curb Box

Old Tap disconnected

TAX ID # 309.12-11-57