

39-43 SOUTH

Labor and Material Report

19 40

Tap at 39-43 South St

(Renewal)

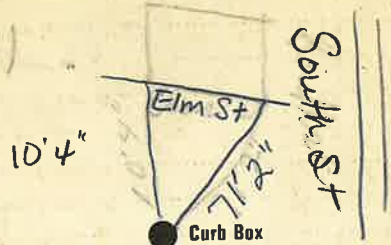

6" Main

(6) ?  
Elev. of Main at tap

Gate at ●

● Gate at

● Curb Box

39-43 SOUTH

St.

Ph

South

Ave. No. 39-43

Name of Owner

TAX ID # 302.20-27-1

Labor and Mat'l. Report

July

19 40

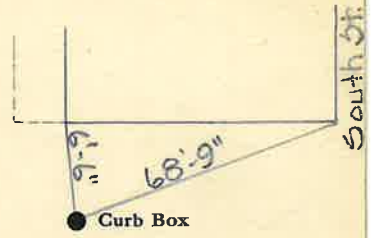

Main

Elm St.

Elev. of Main at tap

Gate at ●

● Gate at

● Curb Box

Curb box set back.  
#41 - corner of South + Elm



LABOR AND MATERIALS

1	Copper	} Connection 1"	\$
<del>Lead</del>			
1	Curb	} Cock Valve } 1" in.	\$
			T. S. & V.
1	Service box	} Short 3 1/2 x 4 1/2 } } Long 4 1/2 x 5 1/2 } } Buff or Rdway }	\$
	Old returned		
35	Ft. 1 in.	} Copper } } G.I. } } C.I. }	Pipe at \$
	Nipples		in. at \$
	Bushings		to in. at \$
	Red'g } Inc'g }	} Coupl'gs to in. at \$	
	Union		in. at \$
	Meter	in. at \$	
	Lead Joints	at \$	
	Compound Joints	at \$	
	Maintenance Foreman	\$	
	Hrs. Water Maint. Man-1	at \$	
	Hrs. Water Maint. Man-2	at \$	
	Hrs. Garage Foreman	at \$	
	Hrs. Labor	at \$	
	Hrs. Compressor	at \$	
	Compensation Ins. at \$	per C \$	
	Trucking	\$	
	Pav't Patch	\$	
	Tap by Miller	\$	
	Giggard & Co.	\$	
	6-24-58	\$	
	O'head	\$	
		\$	

South

St. 35  
Pl. Ave. No. 39

Name of Owner  
Glens Falls Diner

Labor and Mat'l. Report June 24 1958

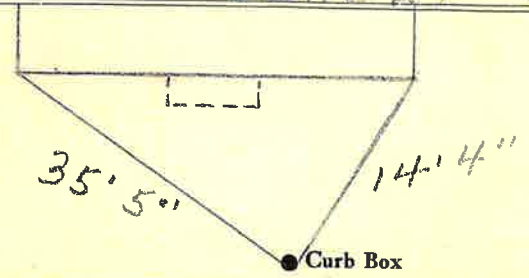

10" Main

Elev. of Main at tap 5 1/2'

Gate at • Gate at

35' to MAIN

1" COPPER

• Curb Box Dec. 10-58

Shot off at curb

Diner Moved.