

LABOR AND MATERIALS

Copper } Connection	\$
Lead }	
Curb { Clock Valve }	in. \$
{ T. S. & V. }	
Service box } Short 3/4 X 4/4 }	\$
Old returned } Long 4/4 X 5/4 }	
{ Buff or Rdway }	
Ft. in. } Copper } Pipe at	\$
{ Galv. Iron }	
{ Cast Iron }	
Nipples in. at	\$
Bushings to in. at	\$
Red'g } Couplings to in. at	\$
Inc'g }	
Union in. at	\$
Meter in. at	\$
Lead Joints at	\$
Compound Joints at	\$
Hrs. Foreman at	\$
Hrs. Chauffeur at	\$
Hrs. Tapper at	\$
Hrs. Labor at	\$
Hrs. Labor at	\$
Hrs. Compressor at	\$
Compensation Ins.	\$
Trucking	\$
Builders Use of Water	\$
<i>WARRINSLEY</i>	\$
.....	\$
.....	\$
.....	\$
.....	\$
.....	\$
.....	\$

St. _____
Pl. _____
Ave. No. _____

Name of Owner *South East Cor*
Rivers

Labor and Mat'l. Report *Clay* 19 *45*

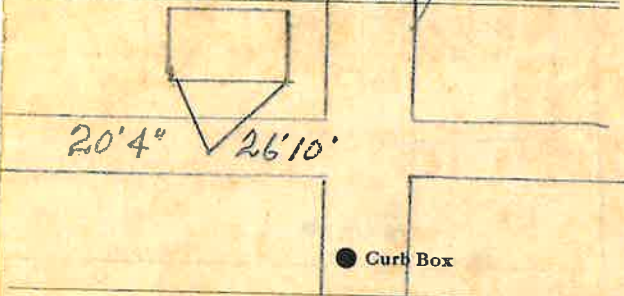

Main Elev. of Main at tap

Gate at ● ● Gate at

● Curb Box

Harry Peterson

