

Labor and Materials

1	Copper	Connection	3/4"	\$ 2.60
1	Lead			
1	Curb	Cock Valve	3/4" in.	\$ 2.27
		T-S & V.		
1	Service Box	Short	3 1/2 x 4 1/2	\$ 1.38
	Old returned	Long	4 x 5 1/2	
		Buff. or Rdway		
23	Ft.	3/4" in. Copper	Pipe at	\$ 4.14
		Galv. Iron		
		Cast Iron		
	Nipples	in. at		\$
	Bushings	to in. at		\$
	Red'g	Couplings	to in. at	\$
	Inc'g			
	Union	in. at		\$
	Meter	in. at		\$
	Lbs. Br. Stone	at		\$
	Lbs. Sand	at		\$
	Bags Cement	at		\$
	Paving Brick	Mack Red Asphalt	at	\$
	Lead Joints	at		\$
	Leadite Joints	at		\$
5	Hrs. Foreman	at		\$ 3.13
2	Hrs. Common Labor	Tapper		\$ 1.-
12	Hrs. Common Labor	at		\$ 5.40
	Hrs. Mason	at		\$
	Hrs. Mason's Helper	at		\$
1 1/2	Hrs. Compressor	at		\$ 1.50
	Compensation Ins			\$ 29
	Trucking			\$ 1.-
	Builders' Use of Water	Patch		\$ 23.-
Total \$				45.71

31-133

143 SOUTH

Labor and Material Report

July 27

1931

3/4" tap at 143 South at

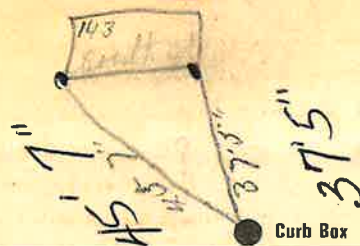

10" Main

Elev of Main at tap 4.76

Gate at 23' to MAIN
3/4" COPPER

Old tap shown at Curb Box