

## LABOR AND MATERIALS

1	Copper Lead	} Connection $\frac{3}{4}$		\$ 1.35
1	Curb { Cock Valve T.S. & V. }	{ $\frac{3}{4}$ in.		\$ 1.80
1	Service Box Old returned	{ Short $3\frac{1}{2} \times 4\frac{1}{2}$ Long $4\frac{1}{2} \times 5\frac{1}{2}$ Buffer Rdway }		\$ 1.70
9	Ft. $\frac{3}{4}$ in.	{ Copper Galv Iron Cast Iron }	Pipe at 18	\$ 1.62
	Nipples	in. at		\$
	Bushings	to in. at		\$
	Red'g Inc'g } Couplings	to in. at		\$
	Union	in. at		\$
	Meter	in. at		\$
	Lead Joints at			\$
	Leadite Joints at			\$
	Hrs. Foreman at			\$
5	Hrs. Chauffeur at	62 $\frac{1}{2}$		\$ 3.13
	Hrs. Tapper at			\$
11	Hrs. Labor at	45		\$ 4.95
	Hrs. Labor at			\$
	Hrs. Compressor at			\$
	Compensation Ins.			\$
	Trucking			\$ .25
	Builders Use of Water			\$ 1-
	Tap by Millman			\$ 5.00
	pipe of hole $3 \times 3\frac{1}{2}$			\$
				\$
				\$
				\$
				\$
				\$ 20.80

71 1941 192 SOUTH

South

St.  
Pl.  
Ave. No. 192

Name of Owner

Carlbert

Labor and Mat'l. Report

Apr 17

1941

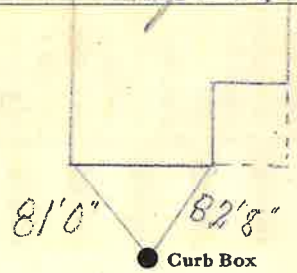

6

Main

Elev. of  
Main at tap. 5

Gate at ●

● Gate at

9' fo MAIN  
 $\frac{3}{4}$ " copper

● Curb Box

TAX ID# 309.12-11-49

to be Billed at 11<sup>00</sup>