

## LABOR AND MATERIALS

1	Copper	Connection	3/4	\$ 2.94	
	Lead				
1	Curb	Cock Valve	3/4 in.	\$ 3.71	
		T. S. & V.			
	Service box	Short 3 1/2 X 4 1/2	Same	—	
	Old returned	Long 4 1/2 X 5 1/2			
		Buff or Rdway			
27	Ft.	3/4 in.	Copper Pipe at	30	\$ 8.10
			G. I.		
			C. I.		
	Nipples	in.	at		\$
	Bushings	to	in.	at	\$
	Red'g				
	Inc'g	Coupl'gs	to	in.	at
	Union	in.	at		\$
	Meter	in.	at		\$
	Lead Joints	at			\$
	Compound Joints	at			\$
2	Hrs.	Water Maint. Man—1	at	1.01	\$ 2.02
4	Hrs.	Water Maint. Man—2	at	.91	\$ 3.64
12	Hrs.	Labor—	at	.80	\$ 9.60
	Hrs.	Labor—	at		\$
	Hrs.	Compressor	at		\$
	Compensation Ins.	at \$	per C		\$ 34
	Trucking				\$ 1.00
	Pav't Patch				\$
	Tap by Muller				\$
	O'head				\$
					\$ 21.35

102

St. \_\_\_\_\_  
 Pl. \_\_\_\_\_  
 Ave. No. 18

*Spring*  
 Name of Owner \_\_\_\_\_  
*Caldwell*

Labor and Mat'l. Report *June 11 1940*

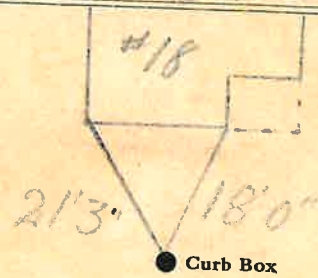

4 Main Elev. of Main at tap 5

Gate at ● Gate at ●

27' to main

3/4" copper ● Curb Box

LSM\*SC 5 15-48 *To be Billed* J