

Labor and Materials

| | | | | |
|---|------------------------|---------------------------------------|----|----|
| 1 | Copper | Connection | \$ | |
| | Lead | | \$ | |
| 1 | Curb | Cock Valve T-S & V. } 3/4" in. | \$ | |
| 1 | Service Box | Short 3/4x1 1/2 | \$ | |
| | Old returned | Long 4x6 1/2 | \$ | |
| | | Buff. or Rdway | \$ | |
| 7 | Ft. 3/4 | Copper Galv. Iron Cast Iron } Pipe at | \$ | |
| | Nipples | in. at | \$ | |
| | Bushings | to in. at | \$ | |
| | Red'g Inc'g | Couplings to in. at | \$ | |
| | Union | in. at | \$ | |
| | Meter | in. at | \$ | |
| | Lbs. Br. Stone | at | \$ | |
| | Lbs. Sand | at | \$ | |
| | Bags Cement | at | \$ | |
| | Paving Brick | Mack Red Asphalt } at | \$ | |
| | Lead Joints | at | \$ | |
| | Leadite Joints | at | \$ | |
| | Hrs. Foreman | at | \$ | |
| | Hrs. Common Labor | at | \$ | |
| | Hrs. Common Labor | at | \$ | |
| | Hrs. Mason | at | \$ | |
| | Hrs. Mason's Helper | at | \$ | |
| | Hrs. Compressor | at | \$ | |
| | Compensation Ins | | \$ | |
| | Trucking | | \$ | |
| | Builders' Use of Water | | \$ | |
| | Total \$ | | | \$ |

Labor and Material Report *Aug 20* 19*28*

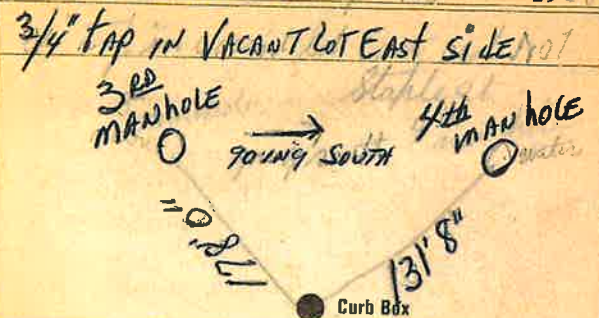

6" Main Elev of Main at tap 4.6

Gate at 7' to MAIN Gate at

3/4" COPPER Curb Box

Pat Hurley #1